



THE waldor LINE

Since 1946

2012

asi 94770 PPAI 114126 UPIC: WALDOR SAGE 57470

www.waldorproducts.com



promotional products that connect to every lifestyle



14

new products



ORDERING POLICY:

- Orders must be received on your purchase order or letterhead:
 - via email: info@waldorproducts.com
 - via FAX: **201-332-6370**
- An acknowledgement will be sent promptly.
- All catalog prices include a straight line imprint.
- All copy must be submitted typed and clearly legible.
- Imprint areas vary by item. See information on each catalog page.
- Layout for imprinting will be at the factory's discretion, except where specific artwork (see below) has been submitted.
- **We stock all standard imprint colors.** No PMS color matches.

• **We ship exact quantities: no overruns – no underruns.**

REPEAT ORDERS: Include our invoice number and the date of the last order for the item. Art is kept on file for three (3) years.

ARTWORK POLICY:

For our Hot Stamping process, even when camera ready copy is supplied, a deep-etched cut is still necessary at \$40.00 (G). If we have to curve copy for you add \$10.00 NET per line.

There is no cut charge on Repeat Orders or for straight line imprint.

Logos and special type should be submitted in clean black and white form. Digital art should be sent via e-mail with a confirming fax. (See Artwork via e-mail below.)

NOTE: *Fax copies, screened, copier or website art, as well as art from a color printer or ink jet printer are not to be considered reproduction quality.*

SUBMISSION OF ARTWORK VIA E-MAIL:

- **E-mail art to - art@waldorproducts.com**
 - Include your company name and PO# in the subject line*
 - **All digital art must be submitted in black only**
 - **All fonts must be converted to outline**
 - **All scans must be bitmapped - No Halftones**
- For our Mac Platform applications** please save your files as:
Adobe Illustrator EPS files (save to version CS5 or lower)
Photoshop (save to version CS4 or lower) as bitmapped EPS or TIFF without compression - no halftones. A minimum resolution of 600 dpi at the final size of your imprint is required.
All fonts must be converted to outline.

From Windows Platform please save your files as:

Adobe Illustrator: save as an EPS file with all fonts converted to outline.
Photoshop: save as an EPS, TIFF or JPEG file at 600 dpi with no compression - no halftones.

Corel Draw and all other applications: convert all fonts to outline, save as or export as an EPS file.

If artwork is submitted on disk, please keep in mind that our Art Department is Macintosh based.

SPECIAL CHARGES:

LESS THAN MINIMUM: Refer to information under each price chart.

CHANGE OF COPY:

- **On Combs** --
 - Add \$5.00 (G) per change.
- **Items priced less than \$1.00 at 250 qty.** --
 - Add \$10.00 (G) per change.
- **Items priced more than \$1.00 at 250 qty.** --
 - Add \$15.00 (G) per change.

SECOND SIDE IMPRINTING:

(Where Possible)

- **On Combs** -- Add \$5.00 (G) set up charge plus 5¢ (G) each running charge.
- **Items priced less than \$1.00 at 250 qty.** -- Add \$10.00 (G) set up charge plus 10¢ (G) each running charge.
- **Items priced more than \$1.00 at 250 qty.** -- Add \$15.00 (G) set up charge plus 15¢ (G) each running charge.

TWO COLOR IMPRINTING:

(Where Possible)

**(500 pc. minimum required) –
use same pricing as for second side imprinting**

PROOFS:

- **On paper / email** - \$12.00 (G)
- **Finished Sample** - \$40.00 (G)

PROTECTIVE PACKAGING: Cello/Poly Bags --

- **On Combs:** Add 7¢ (G) each
- **All other items:** Add 10¢ (G) each.

SPLIT SHIPMENTS: \$3.00 NET each

C.O.D. SHIPMENTS: \$8.00 NET service fee.

CANCELLATIONS: Cancelled orders are subject to all charges incurred to date of cancellation. Completed orders cannot be cancelled.

SHIPPING:

Our preferred shipping methods are UPS and FedEx. All shipments are F.O.B. New Jersey.

TERMS:

- Open Account customers have Net 30 day terms.
- We accept VISA and MASTERCARD for all orders.



- "Cash with Order" customers should submit payment with each order or use their credit card for payment.



We adhere to these sm@rt code artwork standards.



For a full explanation and details refer to - www.smart-artwork.org



New for 2012



The Fashionista Zip Purse
(Style No. 755)
see page 12

Sunny Day Electronics Carrier
(Style No. 560)
see page 25



The Contempo Weekly Pocket Planners
(Style No. 970)
see page 41

The Cosmetique Cosmetic Bag
(Style No. 727)
see page 15



First Class Cosmetic Bag
(Style No. 729) see page 19



Travel Mate
(Style No. 270)
see page 35



Rainbow Colors First Aid Kit
(Style No. 816) see page 22



The White Mesh Twin Zip
(Style No. 942)
see page 9



Card Mate
(Style No. 260)
see page 35



The Sport Wallet
(Style No. 917)
see page 27



Mobile Guard
(Style No. 256)
see page 24



Lunette Magnifier
(Style No. 502)
see page 57

new colors



The Metropolitan Monthly Pocket Planners
(Style No. 615)
see page 39



Fun Color Zip Purse
(new color Navy/Red)
(Style No. 787)
see page 3



iCase eyeglasses/iPod/cell
(new color Royal Blue)
(Style No. 255)
see page 26



Mobile Reminder
(Style No. 706)
see page 55



Metallic Color Monthly Pocket Planner
(new color Steel Gray)
(Style No. 512)
see page 36



The School Mate Pencil Case
(new color Lemon)
(Style No. 728)
see page 21

- Purses** 2-12
- Cosmetic Bags** 13-20
- Pencil Cases** 21
- First Aid Kits** 22-23
- Electronics Carriers** 24-27
- Wallets & ID Carriers** 27-31
- Luggage Tags** 31
- Leather Products** 32-33
- Card Cases** 34-35
- Pocket Calendars** 36-41
- Shopping Bags & Totes** 42-46
- Back Packs** 47
- Coolers** 48-50
- Notebooks** 51-55
- Address Books** 56
- Magnifiers** 56-59
- Personal Care** 60-61
- Carabiners & Keytags** 62-66
- Unbreakable Ad-Combs** 67-69
- Sale Items** 70-73
Close-out products offered at substantially less than EQP.

Visit us any time at
waldorproducts.com

Our web-site now has a Distributor log-in feature that allows you to

- Order on-line
- Check order status
- Print Acknowledgements & Invoices
- Estimate Freight Charges
- Get Tracking Numbers
- Order Catalogs and Samples

and you can now even customize your own web-site by linking our pages with your on-line site.

***Remember ...Waldor does not sell direct to the public, but only through authorized distributors.**

Style No. 790

The Calypso

zip purse

A tropical combo of a cool and frosty vinyl stitched to a bright solid nylon band.



- Pouch neatly stores coins, cash, parking stubs, receipts, ATM/phone/credit cards, loose papers
- Keyring strap attaches inside the pouch, keeping keys secure
- Tempered spring-steel split ring
- Nylon zipper will never rust or snag

	250	500	1000	2500	5000 and over
790	1.19	1.16	1.14	.99	.89
3ABC	Less than 250 quantity, add \$15.00 (G). Absolute Minimum - 100				

Item Size: 4 1/2" w x 3" h
 Colors: SUNSET, SEA GREEN, BERRY, AQUA
 Imprint Color: White or any standard contrasting color
 (Please Indicate)

Imprint Area: 2 1/2" w x 1 1/4" h
 Shipping Weight: 12 lbs. per 250
 Second Side Imprint: See General Information
 on Inside Front Cover

Imported

All catalog prices include a straight line imprint. Add a \$40.00 (G) Die Charge for logos or special type.
 It is our policy to ship exact quantities: no overruns - no underruns.

Style No. 787

the Fun Color zip purse

In our unique and exclusive combo of a suede-style supported vinyl stitched to a coarse-weave nylon band.



New Color Combination
Navy / Red

- Pouch neatly stores coins, cash, parking stubs, receipts, ATM/phone/credit cards, loose papers
- Keyring strap attaches inside the pouch, keeping keys secure
- Tempered spring-steel split ring
- Nylon zipper will never rust or snag

Item Size: 4 1/2" w x 3" h
 Colors: VINYL/Nylon) RED/Black, GREEN/Blue, PURPLE/Green, NAVY/Red (New color)
 Imprint Color: Gold, Silver or White (Please indicate)
 Imprint Area: 2 1/2" w x 1 1/4" h
 Shipping Weight: 14 lbs. per 250
 Second Side Imprint: See General Information on Inside Front Cover

Imported

	250	500	1000	2500	5000 and over
787	1.29	1.25	1.21	1.07	.95
3ABC	Less than 250 quantity, add \$15.00 (G). Absolute Minimum - 100				

All catalog prices include a straight line imprint. Add a \$40.00 (G) Die Charge for logos or special type. It is our policy to ship exact quantities: no overruns - no underruns.

Style No. 786

the Rainbow color zip purse

Four bright, vivid colors in see-thru vinyl
with matching zippers and trim



- Great School item for I.D.s and passes
- Pouch neatly stores coins, cash, phone card, loose papers
- Keyring strap attaches inside the pouch, keeping keys secure
- Tempered spring-steel split ring
- Nylon zipper will never rust or snag

Great \$ Value

	250	500	1000	2500	5000 and over
786	1.09	1.06	1.04	.92	.82
3ABC	Less than 250 quantity, add \$15.00 (G). Absolute Minimum - 100				

Item Size: 4 1/2" w x 3" h
 Colors: BLUE, GREEN, YELLOW, RED
 Imprint Color: White or Black (Please indicate)
 Imprint Area: 2 1/2" w x 1 1/4" h
 Shipping Weight: 12 lbs. per 250
 Second Side Imprint: See General Information
 on Inside Front Cover

Imported

All catalog prices include a straight line imprint. Add a \$40.00 (G) Die Charge for logos or special type.
 It is our policy to ship exact quantities: no overruns - no underruns.

Style No. 788

the **SATEARI**
zip purse

Outfitted with our unique and exclusive combo of a suede-style supported vinyl stitched to a coarse-weave khaki nylon band.

Four Stylish
Color
Combinations



- Pouch neatly stores coins, cash, parking stubs, receipts, ATM/phone/credit cards, loose papers
- Keyring strap attaches inside the pouch, keeping keys secure
- Tempered spring-steel split ring
- Nylon zipper will never rust or snag

	250	500	1000	2500	5000 and over
788	1.29	1.25	1.21	1.07	.95
3ABC	Less than 250 quantity, add \$15.00 (G). Absolute Minimum - 100				

Item Size: 4 1/2" w x 3" h
 Colors: (VINYL / Khaki Nylon) HUNTER, BLACK, BURGUNDY, NAVY
 Imprint Color: Gold, Silver or White (Please indicate)
 Imprint Area: 2 1/2" w x 1 1/4" h
 Shipping Weight: 14 lbs. per 250
 Second Side Imprint: See General Information
 on Inside Front Cover

Imported

All catalog prices include a straight line imprint. Add a \$40.00 (G) Die Charge for logos or special type.
 It is our policy to ship exact quantities: no overruns - no underruns.

Style No. 940

The Twin Zip

A versatile two-tone purse in a suede-style vinyl / microfiber combo featuring two separate zipper compartments and a keyring.



Keyring

BURGUNDY / Khaki

BLACK / Gray

NAVY / Khaki

Separate your bills & coins,
credit cards,
personal items and keys
in one convenient purse.

Item Size: 4 3/4" w x 3 1/8" h
 Colors: BLACK Vinyl / Gray Microfiber,
 BURGUNDY Vinyl / Khaki Microfiber or
 NAVY Vinyl / Khaki Microfiber
 Imprint Color: Gold or Silver (Please indicate)
 Imprint Area: 2 1/2" w x 1 1/4" h
 Shipping Weight: 19 lbs. per 250
 Second Side Imprint Not Available
 Imported

	250	500	1000	2500	5000 and over
940	1.59	1.55	1.50	1.35	1.20
3ABC	Less than 250 quantity, add \$15.00 (G). Absolute Minimum - 100				

All catalog prices include a straight line imprint. Add a \$40.00 (G) Die Charge for logos or special type.
 It is our policy to ship exact quantities: no overruns - no underruns.

Style No. 789

simply *Pink* zip purse

In our unique and exclusive combo of a suede-style supported vinyl stitched to a coarse-weave khaki nylon band.



Keyring

- Pouch holds cosmetics, coins, cash, parking stubs, receipts, ATM/phone/credit cards, loose papers
- Keyring strap attaches inside the pouch, keeping keys secure
- Tempered spring-steel split ring
- Nylon zipper will never rust or snag

Item Size: 4 1/2" w x 3" h
 Colors: PINK VINYL / Khaki Nylon
 Imprint Color: White or Black (Please indicate)
 Imprint Area: 2 1/2" w x 1 1/4" h
 Shipping Weight: 14 lbs. per 250
 Second Side Imprint: See General Information on Inside Front Cover
 Imported

	250	500	1000	2500	5000 and over
789	1.29	1.25	1.21	1.07	.95
3ABC	Less than 250 quantity, add \$15.00 (G). Absolute Minimum - 100				

All catalog prices include a straight line imprint. Add a \$40.00 (G) Die Charge for logos or special type. It is our policy to ship exact quantities: no overruns - no underruns.

Style No. 794

Tropical PEARL zip purse

In Pearl White accented with tropical colored nylon bands.



- Pouch holds cosmetics, coins, cash, parking stubs, receipts, ATM/phone/credit cards, loose papers
- Keyring strap attaches inside the pouch, keeping keys secure
- Tempered spring-steel split ring
- Nylon zipper will never rust or snag

Item Size: 4 1/2" w x 3" h
 Colors: PEARL WHITE Vinyl with Orange, Pink, Lime or Sky Blue Nylon Bands
 Imprint Color: White or any standard color (Please indicate)
 Imprint Area: 2 1/2" w x 1 1/4" h
 Shipping Weight: 12 lbs. per 250
 Second Side Imprint: See General Information on the Inside Front Cover
Imported

	250	500	1000	2500	5000 and over
794	1.19	1.16	1.14	.99	.89
3ABC	Less than 250 quantity, add \$15.00 (G). Absolute Minimum - 100				

All catalog prices include a straight line imprint. Add a \$40.00 (G) Die Charge for logos or special type.
 It is our policy to ship exact quantities: no overruns - no underruns.

Style No. 942

The White Mesh Twin Zip

NEW

A versatile fine mesh & suede-style vinyl purse featuring two separate zipper compartments

Separate your bills & coins, credit cards, personal items and keys in one convenient purse.



	250	500	1000	2500	5000 and over
942	1.69	1.65	1.60	1.42	1.27
3ABC	Less than 250 quantity, add \$15.00 (G). Absolute Minimum - 100				

Item Size: 4 3/8" w x 3 1/8" h
 Colors: BLACK or RED
 Imprint Color: Silver, Gold or White (Please indicate)
 Imprint Area: 2 1/2" w x 1 1/2" h
 Shipping Weight: 15 lbs. per 250
 Second Side Imprint Not Available
 Imported

All catalog prices include a straight line imprint. Add a \$40.00 (G) Die Charge for logos or special type. It is our policy to ship exact quantities: no overruns - no underruns.

Style No. 542

The **CLASSIC** Squeeze Purse

In sculptured supported Vinyl.

Just squeeze
and it opens...
Release and it
snaps shut -
TIGHT!

Great \$ Value



	250	500	1000	2500	5000 and over
542	1.09	1.06	1.04	.92	.82
3ABC	Less than 250 quantity, add \$15.00 (G). Absolute Minimum - 100				

Item Size: 3 1/2" w x 3" h
Colors: BLACK, NAVY, BURGUNDY
Imprint Color: Gold, Silver or White (Please indicate)
Imprint Area: 2" w x 1 1/4" h
Shipping Weight: 11 lbs. per 250
Second Side Imprint: See General Information on Inside Front Cover

Imported

Style No. 795

the **runway** zip purse

A suede-style Red or Royal Blue vinyl stripe stitched to a coarse-weave Black nylon with a matching color back.



- Pouch holds cosmetics, coins, cash, parking stubs, receipts, ATM/phone/credit cards, loose papers
- Keyring strap attaches inside the pouch, keeping keys secure
- Tempered spring-steel split ring
- Nylon zipper will never rust or snag

	250	500	1000	2500	5000 and over
795	1.39	1.35	1.29	1.15	1.05
3ABC	Less than 250 quantity, add \$15.00 (G). Absolute Minimum - 100				

Item Size: 4 3/4" w x 3" h
Colors: RED Vinyl Stripe & Back or ROYAL BLUE Vinyl Stripe & Back with Black Nylon
Imprint Color: Gold, Silver or White (Please indicate)
Imprint Area: 2 1/2" w x 1 1/4" h
Shipping Weight: 13 lbs. per 250
Second Side Imprint Not Available

Imported

All catalog prices include a straight line imprint. Add a \$40.00 (G) Die Charge for logos or special type.
It is our policy to ship exact quantities: no overruns - no underruns.

Style No. 945

THE KANGAROO THREE POCKET PURSE

Khaki microfiber accented with a rich, supple vinyl pocket in Burgundy or Navy



- Three separate pockets -
- (1) A center zip compartment for your bills, coins and personal items
 - (2) A side pocket for your ID & credit cards
 - (3) A zip closure on the back for your keys

Keyring on loop folds into zip pocket

	250	500	1000	2500	5000 and over
945	1.69	1.65	1.60	1.42	1.27
3ABC	Less than 250 quantity, add \$15.00 (G). Absolute Minimum - 100				

Item Size: 4 3/4" w x 3" h

Colors: Khaki Microfiber / VINYL pocket in NAVY or BURGUNDY

Imprint Color: Gold, Silver or White (Please indicate)

Imprint Area: 2 1/2" w x 1 1/4" h

Shipping Weight: 18 lbs. per 250

Second Side Imprint Not Available

Imported

Style No. 785

The SEE THRU ZIP POUCH

Crystal clear vinyl for easy viewing of contents...

Particularly suited for ID Cards, Driver's License & Bus Passes.



	250	500	1000	2500	5000 and over
785	1.09	1.06	1.04	.92	.82
3ABC	Less than 250 quantity, add \$15.00 (G). Absolute Minimum - 100				

Item Size: 4 1/2" w x 2 3/4" h

Color: Clear with Black nylon trim & zipper

Imprint Color: Any standard color (Please indicate)

Imprint Area: 2 1/2" w x 1 1/2" h

Shipping Weight: 14 lbs. per 250

Second Side Imprint: See General Information on Inside Front Cover

Imported

All catalog prices include a straight line imprint. Add a \$40.00 (G) Die Charge for logos or special type. It is our policy to ship exact quantities: no overruns - no underruns.

Style No. 755

NEW

The **FASHIONISTA**
ZIP PURSE

Fabulously fashionable color combinations in glossy pebble finish vinyl.



Item Size: 5" w x 3 1/4" h

Colors: RED / Burnt Orange; SAGE / Burnt Orange;
NAVY / Red

Imprint Color: Gold, White or Black on RED; White or Black on SAGE;
Gold or White on NAVY; (Please Indicate)

Imprint Area: 2 3/4" w x 1 1/4" h

Shipping Weight: 8 lbs. per 100

Second Side Imprint: See General Information on
Inside Front Cover

Imported

	100	250	500	1000	2500 and over
755	2.89	2.84	2.78	2.49	2.25
3ABC	Less than 100 quantity, add \$15.00 (G). Absolute Minimum - 50				

All catalog prices include a straight line imprint. Add a \$40.00 (G) Die Charge for logos or special type.
It is our policy to ship exact quantities: no overruns - no underruns.

Style No. 960

FIRST BLUSH

cosmetic bag with mirror

An attractive combination of a suede-style vinyl front with a microfiber back & gusset.



	100	250	500	1000	2500 and over
960	2.49	2.44	2.38	2.13	1.92
3ABC	Less than 100 quantity, add \$15.00 (G). Absolute Minimum - 50				

Item Size: 7" w x 5" h x 2" d
 Colors: PINK, BLACK
 Imprint Color: White
 Imprint Area: 3 1/2" w x 2" h
 Shipping Weight: 15 lbs. per 100
 Second Side Imprint Not Available
 Imported

All catalog prices include a straight line imprint. Add a \$40.00 (G) Die Charge for logos or special type.
 It is our policy to ship exact quantities: no overruns - no underruns.

Style No. 922

The Net Tote

A fine mesh Cosmetic Bag stitched to a crystal clear vinyl front with matching trim and zipper

For Travel, Sports or the Spa



Black

Pink

Crystal Clear Vinyl front

Fine Mesh bottom & back

Woven Ribbon trim

	250	500	1000	2500	5000 and over
922	1.89	1.85	1.80	1.60	1.45
3ABC	Less than 250 quantity, add \$15.00 (G). Absolute Minimum - 100				

Item Size: 8" w x 5" h
 Colors: BLACK, PINK
 Imprint Color: White or any standard color
 (Please indicate)
 Imprint Area: 3 1/2" w x 2" h
 Shipping Weight: 18 lbs. per 250
 Second Side Imprint Not Available
Imported

All catalog prices include a straight line imprint. Add a \$40.00 (G) Die Charge for logos or special type.
 It is our policy to ship exact quantities: no overruns - no underruns.

Style No. 727

The *Cosmétique* Cosmetic Bag

NEW

In Crystal Clear stitched to colorful ribbon trim
and matching zipper

For Travel, Sports or the Spa



	250	500	1000	2500	5000 and over
727	1.69	1.65	1.60	1.42	1.27
3ABC	Less than 250 quantity, add \$15.00 (G). Absolute Minimum - 100				

Item Size: 7 1/2" w x 5" h x 1 3/4" d

Colors: CRYSTAL CLEAR with RED or BLACK Trim & Zipper

Imprint Color: White or any standard color (Please indicate)

Imprint Area: 3 1/2" w x 2" h

Shipping Weight: 20 lbs. per 250

Second Side Imprint: See General Information on
Inside Front Cover.

Imported

All catalog prices include a straight line imprint. Add a \$40.00 (G) Die Charge for logos or special type.
It is our policy to ship exact quantities: no overruns - no underruns.

Style No. 552

The Triplette

Cosmetic Pouch • Mirror • Tissue Holder



Item Size: 5 3/8" w x 3 7/8" h
 Colors: GRAPHITE or BURGUNDY VINYL with Black Mesh and Trim;
 BLACK VINYL with Black Mesh and Silver Trim
 Imprint Colors: Silver on Graphite & Black; Gold on Burgundy
 Imprint Area: 3" w x 1 1/4" h
 Shipping Weight: 16 lbs. per 100
 Second Side Imprint Not Available
 Imported

	100	250	500	1000	2500 and over
552	2.49	2.44	2.38	2.13	1.92
3ABC	Less than 100 quantity, add \$15.00 (G). Absolute Minimum - 50				

All catalog prices include a straight line imprint. Add a \$40.00 (G) Die Charge for logos or special type.
 It is our policy to ship exact quantities: no overruns - no underruns.

Style No. 722

airline carry-on

for toiletries, cosmetics or prescriptions

Official size for carry-on -- 8" x 8" (one quart capacity)



for men...



for women...



for prescriptions...



Great \$ Value

	250	500	1000	2500	5000 and over
722	1.79	1.75	1.70	1.50	1.35
3ABC	Less than 250 quantity, add \$15.00 (G). Absolute Minimum - 100				

Item Size: 8"w x 8"h x 1 1/2"d
 Colors: CRYSTAL CLEAR or TINTED CLEAR PINK
 Imprint Color: Any standard color (Please indicate)
 Imprint Area: 3 1/2"w x 2"h
 Shipping Weight: 28 lbs. per 250
 Second Side Imprint: See General Information on Inside Front Cover.
Imported

All catalog prices include a straight line imprint. Add a \$40.00 (G) Die Charge for logos or special type.
 It is our policy to ship exact quantities: no overruns - no underruns.

Style No. 924

clearly
pink
cosmetic bag

A smart combination of a fashionable suede-style vinyl with a Crystal Clear base for easy viewing.



Item Size: 8" w x 5" h x 1 1/4" d
 Color: PINK and Crystal Clear Vinyl
 Imprint Color: White
 Imprint Area: 3 1/2" w x 1" h
 Shipping Weight: 19 lbs. per 250
 Second Side Imprint: See General Information on Inside Front Cover.
Imported

	250	500	1000	2500	5000 and over
924	1.89	1.85	1.80	1.60	1.45
3ABC	Less than 250 quantity, add \$15.00 (G). Absolute Minimum - 100				

All catalog prices include a straight line imprint. Add a \$40.00 (G) Die Charge for logos or special type.
 It is our policy to ship exact quantities: no overruns - no underruns.

Style No. 729

FIRST CLASS

NEW

Carry-All for Toiletries & Travel



	250	500	1000	2500	5000 and over
729	1.98	1.95	1.90	1.70	1.55
3ABC	Less than 250 quantity, add \$15.00 (G). Absolute Minimum - 100				

Item Size: 7 1/4" w x 5 7/8" h
 Color: SILVER & CRYSTAL CLEAR Vinyl with Black Microfiber Back
 Imprint Color: White or any contrasting color (Please indicate)
 Imprint Area: 3 1/2" w x 2" h
 Shipping Weight: 20 lbs. per 250
 Second Side Imprint Not Available
 Imported

Style No. 926

The GRAY SACK

A "Retro-style" Cosmetic Bag in matching suede-style vinyl & microfiber with bright pink trim.



	250	500	1000	2500	5000 and over
926	1.98	1.95	1.90	1.70	1.55
3ABC	Less than 250 quantity, add \$15.00 (G). Absolute Minimum - 100				

Item Size: 6 1/4" w x 6" h x 1 5/8" d
 Color: GRAY
 Imprint Color: White, Gold or Silver (Please indicate)
 Imprint Area: 3 1/2" w x 2" h
 Shipping Weight: 23 lbs. per 250
 Second Side Imprint Not Available
 Imported

All catalog prices include a straight line imprint. Add a \$40.00 (G) Die Charge for logos or special type.
 It is our policy to ship exact quantities: no overruns - no underruns.

Style No. 724

THE PEARL TOTE

A Pearl White cosmetic bag accented with designer pastel nylon bands.



- Water-resistant Vinyl
- Slim Design
- Satin Finish
- For Purse, Travel or Sports

Great \$ Value

	250	500	1000	2500	5000 and over
724	1.29	1.25	1.21	1.07	.95
3ABC	Less than 250 quantity, add \$15.00 (G). Absolute Minimum - 100				

Item Size: 7" w x 4 1/2" h
 Colors: PEARL WHITE Vinyl with Sky Blue, Lime or Pink Nylon Bands
 Imprint Color: White or any standard color (Please indicate)
 Imprint Area: 3 1/2" w x 2" h
 Shipping Weight: 19 lbs. per 250
 Second Side Imprint: See General Information on Inside Front Cover
 Imported

Style No. 720

SEE THRU Carry-All

A 7" x 4 1/2" Tote in Crystal Clear See-Thru Vinyl

- Perfect for Cosmetics, School Supplies or just about anything!
- No more fumbling, see exactly what's inside!



Item Size: 7" w x 4 1/2" h
 Color: CRYSTAL CLEAR with Blue Zipper & Trim
 Imprint Color: Any standard color (Please Indicate)
 Imprint Area: 3 1/2" w x 2" h
 Shipping Weight: 12 lbs. per 250
 Second Side Imprint: See General Information on Inside Front Cover
 Imported

	250	500	1000	2500	5000 and over
720	1.29	1.25	1.21	1.07	.95
3ABC	Less than 250 quantity, add \$15.00 (G). Absolute Minimum - 100				

All catalog prices include a straight line imprint. Add a \$40.00 (G) Die Charge for logos or special type.
 It is our policy to ship exact quantities: no overruns - no underruns.

Style No. 728

THE School Mate

Pen & Pencil Case

**New Color
LEMON**

Features:

- Four bright translucent vinyl colors
- 8 1/4" wide, fits full-size pencils
- Matching zippers, trim and pulls



Great \$ Value

	250	500	1000	2500	5000 and over
728	1.39	1.35	1.29	1.15	1.05
3ABC	Less than 250 quantity, add \$15.00 (G). Absolute Minimum - 100				

Item Size: 8 1/4" w x 3 1/2" h
 Colors: Lemon (New), CHERRY, AQUA, SEA GREEN
 Imprint Color: White or any standard contrasting color
 (Please indicate)
 Imprint Area: 3 1/2" w x 1 1/2" h
 Shipping Weight: 18 lbs. per 250
 Second Side Imprint: See General Information on
 Inside Front Cover
Imported

All catalog prices include a straight line imprint. Add a \$40.00 (G) Die Charge for logos or special type.
 It is our policy to ship exact quantities: no overruns - no underruns.

Style No. 816

NEW

rainbow colors First Aid Kit

Perfect for Auto, School locker and Summer camp



Yellow

Green

Blue

Red



Kit Contains:

- 3 Bandages, 3/4"
- 3 Sterile Alcohol Pads
- 1 Antiseptic Towelette
- 1 Sting Relief Pad

Great \$ Value

	250	500	1000	2500	5000 and over
816	1.79	1.75	1.70	1.50	1.35
3ABC	Less than 250 quantity, add \$15.00 (G). Absolute Minimum - 100				

Item Size: 4 1/2" w x 3" h

Colors: YELLOW, GREEN, BLUE, RED

Imprint Color: White

Imprint Area: 2 1/2" w x 1 1/4" h

Shipping Weight: 17 lbs. per 250

Second Side Imprint: See General Information on Inside Front Cover

Imported

All catalog prices include a straight line imprint. Add a \$40.00 (G) Die Charge for logos or special type.
It is our policy to ship exact quantities: no overruns - no underruns.

Style No. 800

FIRST AID Travel Kit

Perfect for Auto, School locker and Summer camp



Kit Contains:

- 3 Bandages, 3/4"
- 3 Sterile Alcohol Pads
- 1 Antiseptic Towelette
- 1 Sting Relief Pad

Great \$ Value

	250	500	1000	2500	5000 and over
800	1.89	1.85	1.80	1.60	1.45
3ABC	Less than 250 quantity, add \$15.00 (G). Absolute Minimum - 100				

Item Size: 4 1/2" w x 3 1/2" h

Colors: ROYAL BLUE, WHITE, RED

Imprint Color: Any contrasting color on White;
White, Silver or Gold on Red or Royal Blue (Please indicate)

Imprint Area: 3" w x 1 1/2" h

Shipping Weight: 18 lbs. per 250

Second Side Imprint Not Available

Imported

All catalog prices include a straight line imprint. Add a \$40.00 (G) Die Charge for logos or special type.
It is our policy to ship exact quantities: no overruns - no underruns.

Style No. 256

NEW

Mobile Guard

Soft Protection for all hand-held Electronics



Soft cushion Vinyl / Neoprene with Tuck flap top

Sewn seams and edging

Royal Blue

Red

Lime

	250	500	1000	2500	5000 and over
256	1.39	1.35	1.29	1.15	1.05
3ABC	Less than 250 quantity, add \$15.00 (G). Absolute Minimum - 100				

Item Size: 3" w x 5" h
 Colors: ROYAL BLUE, RED, LIME
 Imprint Color: Gold, Silver or White
 Imprint Area: 1 3/4" w x 2" h
 Shipping Weight: 7 lbs. per 250
 Second Side Imprint Not Available
 Imported

Style No. 254

i pouch

iPod / cell / electronics

A protective case with a lanyard, carabiner & zip pocket.

WIDER
 Now fits an iPhone



Secure Velcro closure

Carabiner for use with the lanyard or clip to belt loop or back pack

NAVY Vinyl with Khaki Microfiber

Zip Pocket for your cards & cash

BLACK Vinyl with Gray Microfiber

	100	250	500	1000	2500 and over
254	2.59	2.54	2.48	2.22	2.00
3ABC	Less than 100 quantity, add \$15.00 (G). Absolute Minimum - 50				

Item Size: 3 1/4" w x 5 1/4" h
 Colors: NAVY Vinyl / Khaki Microfiber; BLACK Vinyl / Gray Microfiber
 Imprint Color: Gold, Silver or White (Please indicate)
 Imprint Area: 2" w x 1 3/4" h
 Shipping Weight: 16 lbs. per 250
 Second Side Imprint Not Available
 Imported

All catalog prices include a straight line imprint. Add a \$40.00 (G) Die Charge for logos or special type. It is our policy to ship exact quantities: no overruns - no underruns.

Style No. 560

Sunny Day

NEW

ID and Electronics Carrier

Holds your ID, Cell Phone, iPod, MP3 Player or other mobile electronics

Perfect for School Trips or Traveling Sports Teams, Walk-a-Thons, Road Races and other Fundraisers



Clear ID pocket for Student ID, Participant card or Convention Pass

Contrasting Zipper and Lanyard

Royal Blue

Secure Zipper pouch for cellphone or electronics

Breakaway Lanyard

Red

Non-woven and Clear Front with matching Vinyl Back

Great \$ Value

	250	500	1000	2500	5000 and over
560	1.79	1.75	1.70	1.50	1.35
3ABC	Less than 250 quantity, add \$15.00 (G). Absolute Minimum - 100				

Item Size: 4" w x 6" h

Colors: ROYAL BLUE or RED with Yellow Trim

Imprint Color: Silver, Gold or White (Please Indicate)

Imprint Area: 2 1/2" w x 2 1/2" h

Shipping Weight: 20 lbs. per 250

Second Side Imprint Not Available

Imported

All catalog prices include a straight line imprint. Add a \$40.00 (G) Die Charge for logos or special type. It is our policy to ship exact quantities: no overruns - no underruns.

Style No. 255

iCase

eyeglasses/iPod/cell

A protective case for your glasses with an extra pocket for electronics or cell phone.



Carabiner for clipping to belt loop, back pack or lanyard

Microfiber Flap, Top and Back

Outside Vinyl Pocket with secure Velcro closure for Electronics or Cell Phone

Bright Red

Black

New Color Royal Blue

Fully lined and padded Microfiber Zipper Case for Eyeglasses

	100	250	500	1000	2500 and over
255	2.98	2.94	2.88	2.58	2.33
3ABC	Less than 100 quantity, add \$15.00 (G). Absolute Minimum - 50				

Item Size: 3 1/4" w x 6 1/4" h
(Carabiner adds 2" to height)
Colors: ROYAL BLUE (New), RED, BLACK
Imprint Color: Gold, Silver or White (Please indicate)
Imprint Area: 2" w x 2" h
Shipping Weight: 23 lbs. per 250
Second Side Imprint Not Available
Imported

All catalog prices include a straight line imprint. Add a \$40.00 (G) Die Charge for logos or special type.
It is our policy to ship exact quantities: no overruns - no underruns.

Style No. 258

THE COMMUNICATOR

ID / Cell / Electronics Pouch
with Lanyard & Zip Pocket

A convenient electronics
carrier with an ID window for
college & corporate campus
and sports events



	100	250	500	1000	2500 and over
258	2.39	2.34	2.28	2.04	1.83
3ABC	Less than 100 quantity, add \$15.00 (G). Absolute Minimum - 50				

Item Size: 5" w x 3 1/8" h
(Plastic Clip adds 2 1/4" to height)
Colors: BLACK or BRIGHT RED Vinyl with
Black Nylon back
Imprint Color: Gold, Silver or White (Please indicate)
Imprint Area: 2" w x 1 3/4" h
Shipping Weight: 17 lbs. per 250
Second Side Imprint Not Available
Imported

Style No. 917

SPORT WALLET

Slim Style in Microfiber & Supple Vinyl

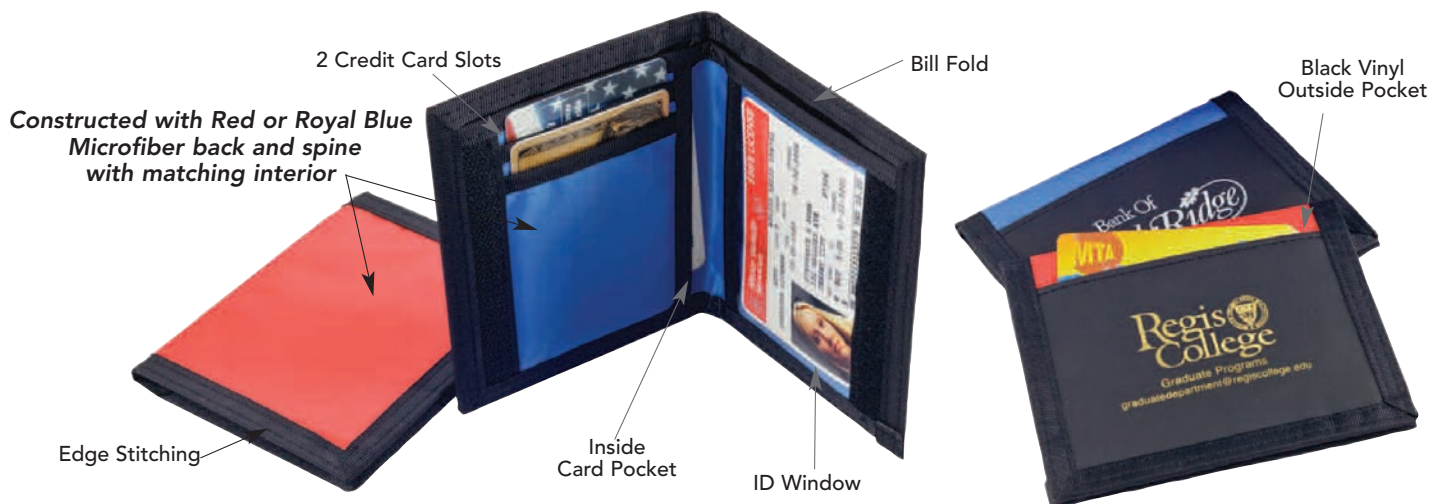

Great \$ Value

	250	500	1000	2500	5000 and over
917	1.98	1.95	1.90	1.70	1.55
3ABC	Less than 250 quantity, add \$15.00 (G). Absolute Minimum - 100				

Item Size: 4 1/2" w x 3 5/8" h
Colors: RED / BLACK or ROYAL BLUE / BLACK
Imprint Color: Gold, Silver or White (Please indicate)
Imprint Area: 2 1/2" w x 1 1/2" h
Shipping Weight: 18 lbs. per 250
Second Side Imprint Not Available
Imported

All catalog prices include a straight line imprint. Add a \$40.00 (G) Die Charge for logos or special type.
It is our policy to ship exact quantities: no overruns - no underruns.

Style No. 526

Carabiner Wallet

in **SATEARI COLORS**

Our unique and exclusive combo of a suede-style supported vinyl stitched to coarse-weave khaki nylon.



Item Size: 4 1/4" w x 3" h
(Carabiner adds 2" to width)

Colors: (VINYL / Khaki Nylon) BLACK, RED, ROYAL BLUE

Imprint Color: Gold, Silver or White (Please indicate)

Imprint Area: 2 1/2" w x 1 1/8" h

Shipping Weight: 19 lbs. per 250

Second Side Imprint Not Available

Imported

	100	250	500	1000	2500 and over
526	2.39	2.34	2.28	2.04	1.83
3ABC	Less than 100 quantity, add \$15.00 (G). Absolute Minimum - 50				

All catalog prices include a straight line imprint. Add a \$40.00 (G) Die Charge for logos or special type.
It is our policy to ship exact quantities: no overruns - no underruns.

Style No. 520

The IDentifier

SECURITY ID CARRIER

Perfect for:
Schools • Employees • Conventions and Meetings



Features:

- Outside ID Display Window
- Inside ID Display Window plus storage pocket
- Secure velcro closure
- Matching color Lanyard with Keyring

	100	250	500	1000	2500 and over
520	2.19	2.15	2.10	1.87	1.67
3ABC	Less than 100 quantity, add \$15.00 (G). Absolute Minimum - 50				

Item Size: 3 1/8" w x 4" h
 Colors: WHITE, RED, NAVY, BLACK (New)
 Imprint Color: White or any standard contrasting color
 (Please Indicate)
 Imprint Area: 1 3/4" w x 2" h
 Shipping Weight: 19 lbs. per 250
 Second Side Imprint Not Available
 Imported

All catalog prices include a straight line imprint. Add a \$40.00 (G) Die Charge for logos or special type.
 It is our policy to ship exact quantities: no overruns - no underruns.

Style No. 530

ID Clip in SAFARI COLORS

with Secure Zip Pocket

Our unique and exclusive combo of a suede-style supported vinyl stitched to coarse-weave Khaki nylon.



Perfect on your Back Pack

On your Brief Case

On your Purse



	250	500	1000	2500	5000 and over
530	1.89	1.85	1.80	1.60	1.45
3ABC	Less than 250 quantity, add \$15.00 (G). Absolute Minimum - 100				

Item Size: 4 1/2" w x 3 1/4" h
 (Plastic Clip adds 2 1/2" to width)
 Colors: (VINYL / Khaki Nylon) BLACK, RED, NAVY
 Imprint Color: Gold, Silver or White (Please indicate)
 Imprint Area: 2 1/2" w x 1 1/4" h
 Shipping Weight: 17 lbs. per 250
 Second Side Imprint Not Available
Imported

All catalog prices include a straight line imprint. Add a \$40.00 (G) Die Charge for logos or special type.
 It is our policy to ship exact quantities: no overruns - no underruns.

zipper wallets

Style No. 946

the runway zipper wallet

A stylish Vinyl / Nylon Wallet with keyring featuring a Red or Royal Blue stripe and a Black Vinyl back.



	250	500	1000	2500	5000 and over
946	1.89	1.85	1.80	1.60	1.45
3ABC	Less than 250 quantity, add \$15.00 (G). Absolute Minimum - 100				

Item Size: 4 3/4" w x 3" h
Colors: RED or ROYAL BLUE Vinyl Stripe with Black Nylon and a Black Vinyl Back
Imprint Color: Gold, Silver or White (Please indicate)
Imprint Area: 2 1/2" w x 1 1/4" h
Shipping Weight: 14 lbs. per 250
Second Side Imprint Not Available
Imported

luggage tags

Style No. 534

bright spot LUGGAGE TAG

Bright Vinyl colors accented with silver trim make your luggage super-easy to spot.

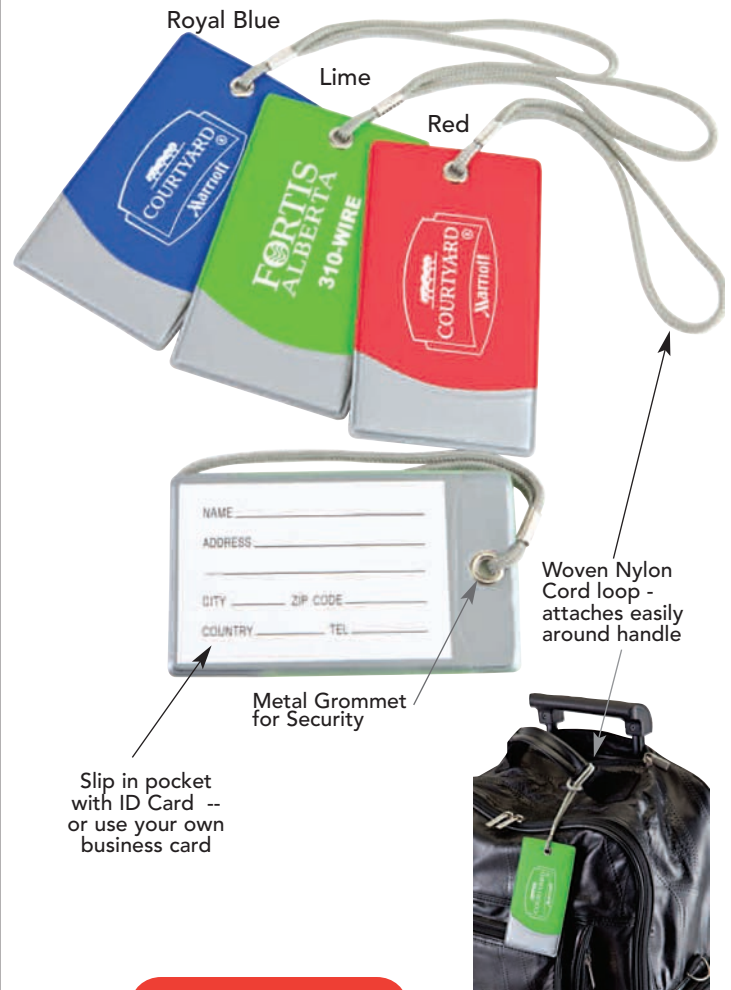

Great \$ Value

	250	500	1000	2500	5000 and over
534	1.19	1.16	1.14	.99	.89
3ABC	Less than 250 quantity, add \$15.00 (G). Absolute Minimum - 100				

Item Size: 4 1/2" w x 2 1/2" h
Colors: ROYAL BLUE, LIME, RED
Imprint Color: White, Silver or Black (Please indicate)
Imprint Area: 2 1/4" w x 1 3/4" h
Shipping Weight: 8 lbs. per 250
Second Side Imprint Not Available.
Imported

All catalog prices include a straight line imprint. Add a \$40.00 (G) Die Charge for logos or special type.
 It is our policy to ship exact quantities: no overruns - no underruns.

Style No. 130

BONDED LEATHER

Commuter Companion

*Total and simple convenience -- credit cards, keys, cash, ID and travel pass...
all in one trim and elegantly detailed wallet*



Item Size: 4 1/4" w x 3 1/4" h
 Colors: BLACK or PINK Bonded Leather
 Imprint Color: Gold on Black, White on Pink
 Imprint Area: 2 1/4" w x 1" h
 Shipping Weight: 7 lbs. per 50
 Second Side Imprint Not Available
 Imported

	50	100	250	500	1000 and over
130	4.99	4.94	4.90	4.40	3.99
3ABC	Less than 50 quantity, add \$15.00 (G). Absolute Minimum - 25				

All catalog prices include a straight line imprint. Add a \$40.00 (G) Die Charge for logos or special type.
 It is our policy to ship exact quantities: no overruns - no underruns.

Style No. 110

BONDED LEATHER

Money Clip Wallet

Compact, Ultra-slim, Efficient and Secure

Each item is packed in a Gift Box

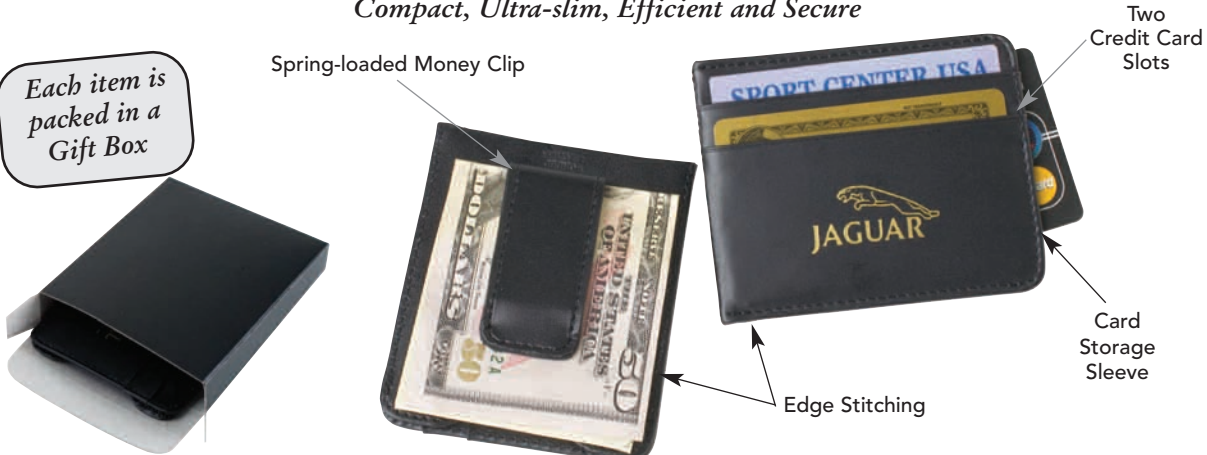

	50	100	250	500	1000 and over
110	4.29	4.22	4.16	3.73	3.37
3ABC	Less than 50 quantity, add \$15.00 (G). Absolute Minimum - 25				

Item Size: 3 3/4" w x 3" h
 Color: BLACK Bonded Leather
 Imprint Color: Gold
 Imprint Area: 2" w x 1" h
 Shipping Weight: 6 lbs. per 50
 Second Side Imprint Not Available
 Imported

Style No. 120

BONDED LEATHER

Executive Card Wallet

Holds a stack of Business Cards with slots & pockets for Credit Cards & Receipts



	50	100	250	500	1000 and over
120	4.29	4.22	4.16	3.73	3.37
3ABC	Less than 50 quantity, add \$15.00 (G). Absolute Minimum - 25				

Item Size: 4 1/8" w x 3 1/8" h
 Color: BLACK Bonded Leather
 Imprint Color: Gold
 Imprint Area: 2 1/2" w x 1" h
 Shipping Weight: 7 lbs. per 50
 Second Side Imprint Not Available
 Imported

All catalog prices include a straight line imprint. Add a \$40.00 (G) Die Charge for logos or special type.
 It is our policy to ship exact quantities: no overruns - no underruns.

card cases

Style No. 916



Features:

- A rich, supple vinyl protective case
- Eight clear card sleeves that swivel easily in and out



Item Size: 3" w x 4" h
 Colors: BLACK, NAVY, BURGUNDY
 Imprint Color: Gold or Silver (Please indicate)
 Imprint Area: 1 3/4" w x 1 3/4" h
 Shipping Weight: 18 lbs. per 250
 Second Side Imprint: See General Information on Inside Front Cover
 Imported

	250	500	1000	2500	5000 and over
916	1.59	1.55	1.50	1.35	1.20
3ABC	Less than 250 quantity, add \$15.00 (G). Absolute Minimum - 100				

Style No. 524

Card Organizer

Stores all your credit cards in a compact booklet-style case.

Traditional Color Vinyl Cases

Features:

- Six clear vinyl sections for twelve or more cards
- Two year calendar



Item Size: 3 1/4" w x 4" h
 Colors: HUNTER GREEN, BLACK, VINTAGE BURGUNDY, NAVY
 Imprint Color: Gold or any standard contrasting color (Please indicate)
 Imprint Area: 2 1/4" w x 2 1/4" h
 Shipping Weight: 17 lbs. per 250
 Second Side Imprint - See General Information on Inside Front Cover
 Imported

	250	500	1000	2500	5000 and over
524	1.59	1.55	1.50	1.35	1.20
3ABC	Less than 250 quantity, add \$15.00 (G). Absolute Minimum - 100				

All catalog prices include a straight line imprint. Add a \$40.00 (G) Die Charge for logos or special type.
 It is our policy to ship exact quantities: no overruns - no underruns.

Style No. 260

Card Mate

BUSINESS CARD CASE

NEW



Great \$ Value

	250	500	1000	2500	5000 and over
260	.59	.58	.57	.51	.45
3ABC	Less than 250 quantity, add \$10.00 (G). Absolute Minimum - 100				

Item Size: 4" w x 2 1/2" h
 Colors: BLACK, NAVY, BURGUNDY
 Imprint Color: Gold, Silver or White (Please indicate)
 Imprint Area: 3" w x 1 1/4" h
 Shipping Weight: 6 lbs. per 250
 Second Side Imprint: See General Information on Inside Front Cover
 Made in the U.S. A.

Style No. 270

Travel Mate

Auto ID / Passport Case

NEW



Great \$ Value

	250	500	1000	2500	5000 and over
270	.59	.58	.57	.51	.45
3ABC	Less than 250 quantity, add \$10.00 (G). Absolute Minimum - 100				

Item Size: 4" w x 5 3/4" h
 Colors: BLACK, NAVY, BURGUNDY
 Imprint Color: Gold, Silver or White (Please indicate)
 Imprint Area: 3" w x 2" h
 Shipping Weight: 8 lbs. per 250
 Second Side Imprint Not Available
 Made in the U.S. A.

All catalog prices include a straight line imprint. Add a \$40.00 (G) Die Charge for logos or special type.
 It is our policy to ship exact quantities: no overruns - no underruns.

Style No. 508

CLASSIC Colors

Bound in high-gloss stiff cover stock



Black



Red



- All Waldor Monthly Pocket Planners feature:**
- A 13 Month 32 page Planner with all of the holidays highlighted and plenty of room to jot down appointments, reminders and important dates
 - Year-at-a-glance current calendar, plus previous and following year
 - Separate sections for Personal ID information, important Telephone Numbers, Advance Planning plus a handy Weights and Measures Chart

Style No. 512

METALLIC Colors

Bound in satin-finish stiff cover stock



Steel Blue

Satin Mauve

Burnished Copper

New Color Steel Gray

Great \$ Value

	250	500	1000	2500	5000 and over
508 } 512 }	.79	.78	.77	.69	.62
3ABC	Less than 250 quantity, add \$10.00 (G). Absolute Minimum - 100				

Item Size: 3 1/2" w x 5 1/2" h
 Colors: #508 Classic RED, Classic BLACK
 #512 STEEL BLUE, SATIN MAUVE,
 BURNISHED COPPER, STEEL GRAY (New)
 Imprint Color: #508 - Gold; #512 - White
 Imprint Area: 2 1/2" w x 2 1/2" h
 Shipping Weight: 13 lbs. per 250
 Second Side Imprint: See General Information on Inside Front Cover

Made in U.S.A.

All catalog prices include a straight line imprint. Add a \$40.00 (G) Die Charge for logos or special type.
 It is our policy to ship exact quantities: no overruns - no underruns.

Style No. 630

Attaché
COLORS

Bound in pebble finish stiff cover stock



All Waldor Monthly Pocket Planners feature:

- A 13 Month 32 page Planner with all of the holidays highlighted and plenty of room to jot down appointments, reminders and important dates
- Year-at-a-glance current calendar, plus previous and following year
- Separate sections for Personal ID information, important Telephone Numbers, Advance Planning plus a handy Weights and Measures Chart

Style No. 612

MARBLE ELEGANCE

BOUND IN LUSTROUS STIFF COVER STOCK



	250	500	1000	2500	5000 and over
630 } 612 }	.89	.87	.85	.75	.67
3ABC	Less than 250 quantity, add \$10.00 (G). Absolute Minimum - 100				

Item Size: 3 1/2" w x 5 1/2" h
Colors: #630 -- NAVY, BURGUNDY, FOREST GREEN
#612 - BLACK Marble, BLUE Marble

Imprint Color: Gold
Imprint Area: 2 1/2" w x 2 1/2" h
Shipping Weight: 14 lbs. per 250
Second Side Imprint: See General Information on Inside Front Cover

Made in U.S.A.

All catalog prices include a straight line imprint. Add a \$40.00 (G) Die Charge for logos or special type.
It is our policy to ship exact quantities: no overruns - no underruns.

Style No. 510

Traditional Color Vinyl Cases

Three New Colors



- All Waldor Monthly Pocket Planners feature:**
- A 13 Month 32 page Planner with all of the holidays highlighted and plenty of room to jot down appointments, reminders and important dates
 - Year-at-a-glance current calendar, plus previous and following year
 - Separate sections for Personal ID information, important Telephone Numbers, Advance Planning plus a handy Weights and Measures Chart

Item Size: 3 3/4" w x 5 3/4" h

510 Colors: VINTAGE BURGUNDY, BLACK, HUNTER GREEN, NAVY, GRAY, WHITE, RED
Imprint Color: Gold or any standard contrasting color (Please indicate)

620 Colors: LIME, GRAPE, ORANGE, BLUEBERRY,
Imprint Color: Black or any standard contrasting color (Please indicate)

Imprint Area: 2 1/2" w x 2 1/2" h
Shipping Weight: 22 lbs. per 250
Second Side Imprint: See General Information on Inside Front Cover

Made In U.S.A.



Style No. 620

TechnoColor VINYL CASES



	250	500	1000	2500	5000 and over
510	1.19	1.16	1.14	.99	.89
620	1.29	1.25	1.21	1.07	.95
3ABC	Less than 250 quantity add \$15.00 (G). Absolute Minimum - 100				

Planner Refills 45¢ each (G).

All catalog prices include a straight line imprint. Add a \$40.00 (G) Die Charge for logos or special type. It is our policy to ship exact quantities: no overruns - no underruns.

Style No. 610

Deluxe Cowhide Textured Vinyl Cases

with GOLD CORNERS



Black

Burgundy

Navy

Gold
Corners

	250	500	1000	2500	5000 and over
610	1.59	1.55	1.50	1.35	1.20
3ABC	Less than 250 quantity, add \$15.00 (G). Absolute Minimum - 100				

Planner Refills 45¢ each (G).

Item Size: 3 3/4" w x 5 3/4" h
 Colors: BLACK, BURGUNDY, NAVY
 Imprint Color: Gold
 Imprint Area: 2 1/2" w x 2 1/2" h
 Shipping Weight: 23 lbs. per 250
 Second Side Imprint: See General Information on
 Inside Front Cover
Imported Cover, Book Printed in the U.S.A.



Gift Box
available for
12¢ (G).
Box ships flat.

NEW

- All Waldor Monthly Pocket Planners feature:
- A 13 Month 32 page Planner with all of the holidays highlighted and plenty of room to jot down appointments, reminders and important dates
 - Year-at-a-glance current calendar, plus previous and following year
 - Separate sections for Personal ID information, important Telephone Numbers, Advance Planning plus a handy Weights and Measures Chart

Style No. 615

The METROPOLITAN

Navy or Black textured vinyl
stitched to a satin-finish Tan spine & back

	250	500	1000	2500	5000 and over
615	1.89	1.85	1.80	1.60	1.45
3ABC	Less than 250 quantity, add \$15.00 (G). Absolute Minimum - 100				

Planner Refills 45¢ each (G).

Item Size: 3 3/4" w x 5 3/4" h
 Colors: NAVY or BLACK with Tan vinyl spine & back
 Imprint Color: Gold or Silver (Please indicate)
 Imprint Area: 1 3/4" w x 2 1/2" h
 Shipping Weight: 23 lbs. per 250
 Second Side Imprint: See General Information on
 Inside Front Cover

Imported Cover, Book Printed in the USA



Navy

Black

All catalog prices include a straight line imprint. Add a \$40.00 (G) Die Charge for logos or special type.
 It is our policy to ship exact quantities: no overruns - no underruns.

Style No. 990

The EXECUTIVE

Tan Latigo Vinyl Case Framed in Black



Style No. 590

The DELUXE

Traditional Color Vinyl Cases



128 Weekly Planner Pages Feature:

- A Full Year's Planning... ONE WEEK AT A TIME - with plenty of room for jotting down daily appointments and important dates
- 2 Year Reference Calendar
- Holidays
- Advanced Planning
- Address-Telephone Directory
- Special Dates to Remember

Plus...

- Weights & Measures including Metric Equivalents
- Calorie Counter
- Identification
- His & Her Apparel Sizes
- First Aid Tips
- 5" Standard & Metric Rulers
- Automobile Business Mileage Summary
- Travelling Distance
- Extra Pages for Notes

Gift Box available for 12¢ (G). Box ships flat.

Great \$ Value

	100	250	500	1000	2500 and over
990	2.39	2.34	2.28	2.04	1.83
3ABC	Less than 100 quantity, add \$15.00 (G). Absolute Minimum - 50				

Planner Refills 75¢ each (G).

Item Size: 3 1/2" w x 6" h
 Colors: TAN LATIGO Framed in Black
 Imprint Color: Gold
 Imprint Area: 2 1/2" w x 2 1/2" h
 Shipping Weight: 16 lbs. per 100
 Second Side Imprint: See General Information on Inside Front Cover
 Imported Cover, Book Printed in the U.S.A.

	100	250	500	1000	2500 and over
590	2.19	2.15	2.10	1.87	1.67
3ABC	Less than 100 quantity, add \$15.00 (G). Absolute Minimum - 50				

Planner Refills 75¢ each (G).

Item Size: 3 1/2" w x 6" h
 Colors: HUNTER GREEN, BLACK, VINTAGE BURGUNDY, NAVY
 Imprint Color: Gold or any standard contrasting color
 (Please indicate)
 Imprint Area: 2 1/2" w x 2 1/2" h
 Shipping Weight: 16 lbs. per 100
 Second Side Imprint: See General Information on Inside Front Cover
 Made in U.S.A.

All catalog prices include a straight line imprint. Add a \$40.00 (G) Die Charge for logos or special type. It is our policy to ship exact quantities: no overruns - no underruns.

Style No. 970

The Contempo

Navy or Black textured vinyl stitched to a satin-finish Tan accent corner

NEW

Style No. 690

The DIRECTOR

Cowhide Textured Vinyl Cases



Navy

Black



Gold Corners

New Color Navy

Gift Box available for 12¢ (G).
Box ships flat.

128 Weekly Planner Pages Feature:

- A Full Year's Planning... ONE WEEK AT A TIME - with plenty of room for jotting down daily appointments and important dates
- 2 Year Reference Calendar
- Holidays
- Advanced Planning
- Address-Telephone Directory
- Special Dates to Remember

Plus...

- Weights & Measures including Metric Equivalents
- Calorie Counter
- Identification
- His & Her Apparel Sizes
- First Aid Tips
- 5" Standard & Metric Rulers
- Automobile Business Mileage Summary
- Travelling Distance
- Extra Pages for Notes

	100	250	500	1000	2500 and over
970	2.69	2.64	2.58	2.31	2.08
690	2.49	2.44	2.38	2.13	1.92
3ABC	Less than 100 quantity, add \$15.00 (G). Absolute Minimum - 50				

Planner Refills 75¢ each (G).

Item Size: 3 1/2" w x 6" h
Colors: 970 - NAVY or BLACK with Tan vinyl accent corner
690 - BLACK or NAVY (New)

Imprint Color: Gold
Imprint Area: 2 1/2" w x 2 1/2" h
Shipping Weight: 16 lbs. per 100
Second Side Imprint: See General Information on Inside Front Cover

Imported Cover, Book Printed in the U.S.A.

All catalog prices include a straight line imprint. Add a \$40.00 (G) Die Charge for logos or special type.
It is our policy to ship exact quantities: no overruns - no underruns.

Style No. 830

The Shopper

**Folding Shopping Bag
in a slim Zip Case**

Available
in two
color
combinations

Nylon
Shopping Bag
easily unfolds to
9" w x 14" h x 3 7/8" d



Easy carry handles



One Piece
Construction.
Shopping Bag
simply refolds
into zip case
for reuse.

NAVY Vinyl with
Dark Green Nylon shopping bag

RED Vinyl with
Black Nylon
shopping bag

Zipper pocket
for cash, cards or keys

Item Size: Zip Case Closed - 5" w x 4 1/4" h;
Shopping Bag Open - 9" w x 14" h x 3 7/8" d
Colors: RED Vinyl Case / Black Nylon shopping bag;
NAVY Vinyl Case / Dark Green Nylon shopping bag
Imprint Color: Gold, Silver or White (Please indicate)
Imprint Area: 2 1/2" w x 1 1/2" h
Shipping Weight: 12 lbs. per 100
Second Side Imprint Not Available
Imported

	100	250	500	1000	2500 and over
830	2.59	2.54	2.48	2.22	2.00
3ABC	Less than 100 quantity, add \$15.00 (G). Absolute Minimum - 50				

All catalog prices include a straight line imprint. Add a \$40.00 (G) Die Charge for logos or special type.
It is our policy to ship exact quantities: no overruns - no underruns.

Style No. 828

Supermarket Shopper

Fully sewn handles and reinforced edges

Extra-Large folding Shopping Bag with a convenient built-in snap case

Non-Woven shopping bag is made of water-resistant Polypropylene.

Easily unfolds to 14 3/4" w x 18 3/4" h x 4" d



RED Vinyl with RED Non-Woven Shopping Bag

Snap Closure



NAVY Vinyl with NAVY Non-Woven Shopping Bag

Outside storage pocket for coupons and receipts.

LIME Vinyl with LIME Non-Woven Shopping Bag

Fully sewn edging in Non-Woven White

Item Size: Snap Case Closed - 7 1/2" w x 4" h
 Shopping Bag Open - 14 3/4" w x 18 3/4" h x 4" d
 Colors: RED Vinyl / RED Non-Woven Shopping Bag;
 NAVY Vinyl / NAVY Non-Woven Shopping Bag;
 LIME Vinyl / LIME Non-Woven Shopping Bag

Imprint Color: Gold, Silver or White (Please indicate)

Imprint Area: 3 1/2" w x 1 3/4" h

Shipping Weight: 13 lbs. per 100

Second Side Imprint Not Available

Imported

	100	250	500	1000	2500 and over
828	2.29	2.24	2.18	1.95	1.75
3ABC	Less than 100 quantity, add \$15.00 (G). Absolute Minimum - 50				

All catalog prices include a straight line imprint. Add a \$40.00 (G) Die Charge for logos or special type. It is our policy to ship exact quantities: no overruns - no underruns.

Style No. 824

Shopalong Shoulder Tote

Folding Shopper's Carry-all

**Folding
Shopping Tote
with
13" Shoulder Drop
in a convenient
slim Zip Case**

Non-Woven bag
is made of
water-resistant Polypropylene.

Easily unfolds to
11" w x 12" h x 4" d



Item Size: Zip Pouch Closed 5" w x 4" h
Tote Bag Open: 11" w x 12" h x 4" gusset
Color: BLACK
Imprint Color: White, Gold or Silver (Please indicate)
Imprint Area: 3" w x 2" h
Shipping Weight: 10 lbs. per 100
Second Side Imprint Not Available
Imported

	100	250	500	1000	2500 and over
824	2.98	2.94	2.88	2.58	2.33
3ABC	Less than 100 quantity, add \$15.00 (G). Absolute Minimum - 50				

All catalog prices include a straight line imprint. Add a \$40.00 (G) Die Charge for logos or special type.
It is our policy to ship exact quantities: no overruns - no underruns.

Style No. 826

Handy Tote

Convenient folding Tote Bag with a built-in snap case perfect for shopping, work, travel or picnics



RED Non-Woven Bag with BLACK Vinyl Case



LIME Non-Woven Bag & Vinyl Case



ROYAL BLUE Non-Woven Bag & Vinyl Case



Great \$ Value

	250	500	1000	2500	5000 and over
826	1.98	1.95	1.90	1.70	1.55
3ABC	Less than 250 quantity, add \$15.00 (G). Absolute Minimum - 100				

Non-Woven Tote Bag is made of water-resistant Polypropylene.

Easily unfolds to 12 1/4" w x 12 3/4" h x 3 1/2" d

Item Size: Snap Case Closed - 6" w x 3 1/2" h
 Tote Bag Open - 12 1/4" w x 12 3/4" h x 3 1/2" d
 Colors: BLACK Vinyl / RED Non-Woven Bag;
 ROYAL BLUE Vinyl & Non-Woven Bag;
 LIME Vinyl & Non-Woven Bag
 Imprint Colors: Gold, Silver or White (Please indicate)
 Imprint Area: 3 1/2" w x 1 1/2" h
 Shipping Weight: 20 lbs. per 250
 Second Side Imprint Not Available
 Imported

All catalog prices include a straight line imprint. Add a \$40.00 (G) Die Charge for logos or special type. It is our policy to ship exact quantities: no overruns - no underruns.

Style No. 834

The Clip'n Go Shopper

**Foldable Shopping Bag
in a Vinyl Snap Pouch
with a
Sturdy Plastic Clip**



NAVY Vinyl/Royal Blue Nylon Pouch & Shopping Bag



Available in two color combinations



RED Vinyl/Black Nylon Pouch & Shopping Bag

Nylon Shopping Bag easily unfolds to 12" w x 14" h x 3" d



Clip securely attaches to pocket book or travel case.

Shopping Bag simply tucks into snap pouch for reuse.

	100	250	500	1000	2500 and over
834	2.39	2.34	2.28	2.04	1.83
3ABC	Less than 100 quantity, add \$15.00 (G). Absolute Minimum - 50				

Item Size: Pouch w/Clip - 7" x 3";
Shopping Bag 12" w x 14" h x 3" d
Colors: RED Vinyl/ Black Nylon pouch & shopping bag;
NAVY Vinyl/ Royal Blue Nylon pouch & shopping bag
Imprint Color: Gold, Silver or White (Please indicate)
Imprint Area: 2" x 1 1/2"
Shipping Weight: 9 lbs. per 100
Second Side Imprint Not Available
Imported

All catalog prices include a straight line imprint. Add a \$40.00 (G) Die Charge for logos or special type.
It is our policy to ship exact quantities: no overruns - no underruns.

Style No. 836

School Time Back Pack

- Ultra-Light
- Compact
- Foldable



Matching Nylon Shoulder Straps

Nylon Back Pack --
13 3/4" w x 16 1/2" h x 4" d

Royal Blue

Bright Red

Back Pack folds easily into snap closure
for pocket size case

	100	250	500	1000	2500 and over
836	2.59	2.54	2.48	2.22	2.00
3ABC	Less than 100 quantity, add \$15.00 (G). Absolute Minimum - 50				

Item Size: Closed: 5" w x 4 1/2" h
Back Pack: 13 3/4" w x 16 1/2" h x 4" d
Colors: ROYAL BLUE Vinyl/Nylon Back Pack; or
BRIGHT RED Vinyl/Nylon Back Pack
Imprint Color: Gold, Silver or White (Please indicate)
Imprint Area: 3" w x 1 1/2" h
Shipping Weight: 14 lbs. per 100
Second Side Imprint Not Available
Imported

All catalog prices include a straight line imprint. Add a \$40.00 (G) Die Charge for logos or special type.
It is our policy to ship exact quantities: no overruns - no underruns.

Style No. 848

KOOL IT

Non-Woven Insulated Lunch Bag

In your choice of three bright colors with a black top, back & bottom



- Features:
- Leak-proof lining
 - Zips along the top edge

- Perfect for --
- Lunches & picnics
 - Sports drinks & snacks
 - Baby gear

	100	250	500	1000	2500 and over
848	2.98	2.94	2.88	2.58	2.33
3ABC	Less than 100 quantity, add \$15.00 (G). Absolute Minimum - 50				

Item Size: 8" w x 6" h x 5 1/2" d
 Colors: ROYAL BLUE, RED, LIME
 Imprint Color: White, Gold or Silver (Please Indicate)
 Imprint Area: 4" w x 2" h
 Shipping Weight: 22 lbs. per 100
 Second Side Imprint Not Available
 Imported

All catalog prices include a straight line imprint. Add a \$40.00 (G) Die Charge for logos or special type.
 It is our policy to ship exact quantities: no overruns - no underruns.

Style No. 847

KOOL TOTE

Foldable, Non-Woven Insulated Lunch Bag



Folds to
7" w x 5 1/4" h
for easy carrying

	100	250	500	1000	2500 and over
847	2.69	2.64	2.58	2.31	2.08
3ABC	Less than 100 quantity, add \$15.00 (G). Absolute Minimum - 50				

Item Size: Open - 7" w x 9 1/2" h x 4" d;
Closed - 7" w x 5 1/4" h
Colors: LEMON, LIME, ROYAL BLUE
Imprint Color: White, Gold or Silver (Please Indicate)
Imprint Area: 3 1/2" w x 2" h
Shipping Weight: 14 lbs. per 100
Second Side Imprint Not Available
Imported

All catalog prices include a straight line imprint. Add a \$40.00 (G) Die Charge for logos or special type.
It is our policy to ship exact quantities: no overruns - no underruns.

Style No. 844

KOOLSAK

Insulated Lunch Bag

in Cobalt Satin Finish Vinyl

165 cubic inches of cool storage



14" black nylon carry strap

Velcro closure



Fully Lined with White Vinyl



Perfect carrier for:

- Lunches and picnics
- Sports drinks & snacks

Great \$ Value

	100	250	500	1000	2500 and over
844	2.39	2.34	2.28	2.04	1.83
3ABC	Less than 100 quantity, add \$15.00 (G). Absolute Minimum - 50				

Item Size: 7" w x 9 1/4" h x 3 1/2" d
 Color: COBALT
 Imprint Color: White
 Imprint Area: 4" w x 2" h
 Shipping Weight: 25 lbs. per 100
 Second Side Imprint: See General Information on Inside Front Cover
Imported

All catalog prices include a straight line imprint. Add a \$40.00 (G) Die Charge for logos or special type.
 It is our policy to ship exact quantities: no overruns - no underruns.

Style No. 798

DELUXE Note Jotter With PEN

*Rich, supple
Burgundy or Navy vinyl
edge - stitched
to a matching microfiber
creates an
elegant impression.*



	100	250	500	1000	2500 and over
798	2.29	2.24	2.18	1.95	1.75
3ABC	Less than 100 quantity, add \$15.00 (G). Absolute Minimum - 50				

Item Size: 4" w x 5 1/4" h
 Colors: BURGUNDY Vinyl / Microfiber;
 NAVY Vinyl / Microfiber
 Imprint Color: Gold
 Imprint Area: 2 1/4" w x 2" h
 Shipping Weight: 22 lbs. per 100
 Second Side Imprint Not Available
Imported

All catalog prices include a straight line imprint. Add a \$40.00 (G) Die Charge for logos or special type.
 It is our policy to ship exact quantities: no overruns - no underruns.

Style No. 694

Small, practical & totally efficient...

SPORTNOTE
NOTEBOOK & PEN

... casual sensibility with extraordinary detailing...

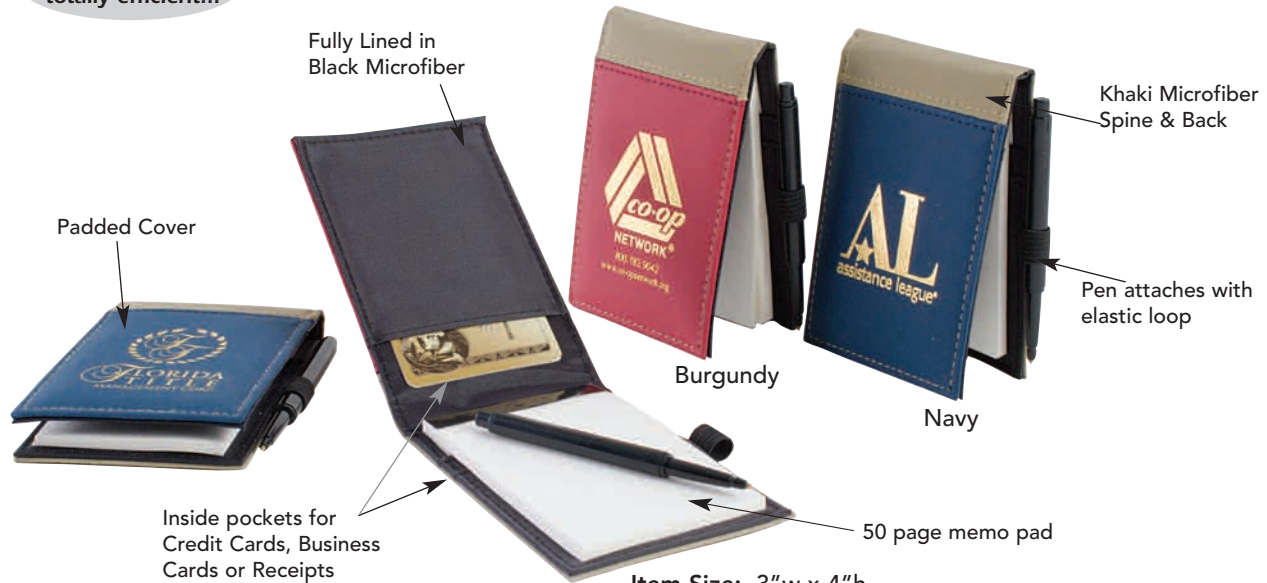

Item Size: 3" w x 4" h
 Colors: NAVY Vinyl / Khaki Microfiber;
 BURGUNDY Vinyl / Khaki Microfiber
 Imprint Color: Gold, Silver or White (Please indicate)
 Imprint Area: 1 3/4" w x 2" h
 Shipping Weight: 25 lbs. per 250
 Second Side Imprint Not Available
 Imported

	250	500	1000	2500	5000 and over
694	1.79	1.75	1.70	1.50	1.35
3ABC	Less than 250 quantity, add \$15.00 (G). Absolute Minimum - 100				

Style No. 583

NOTE Jotter in Traditional Color Vinyl Cases
with 2 Year Calendar Card



Item Size: 3" w x 4 1/2" h
 Colors: HUNTER GREEN, BLACK, VINTAGE BURGUNDY, NAVY
 Imprint Color: Gold or any standard contrasting color (Please indicate)
 Imprint Area: 2 1/4" w x 2 1/2" h
 Shipping Weight: 18 lbs. per 250
 Second Side Imprint: See General Information on Inside Front Cover
 Made in U.S.A.

Great \$ Value

	250	500	1000	2500	5000 and over
583	1.19	1.16	1.14	.99	.89
3ABC	Less than 250 quantity, add \$15.00 (G). Absolute Minimum - 100				

All catalog prices include a straight line imprint. Add a \$40.00 (G) Die Charge for logos or special type.
 It is our policy to ship exact quantities: no overruns - no underruns.

Style No. 693

TEKNOTE
NOTEBOOK & PEN

... modern sensibility with extraordinary detailing...



Small, practical & totally efficient...

	250	500	1000	2500	5000 and over
693	1.79	1.75	1.70	1.50	1.35
3ABC	Less than 250 quantity, add \$15.00 (G). Absolute Minimum - 100				

Item Size: 3" w x 4" h
Colors: GRAPHITE Vinyl / Black Microfiber
Imprint Color: Silver
Imprint Area: 1 3/4" w x 2" h
Shipping Weight: 25 lbs. per 250
Second Side Imprint Not Available
Imported

Style No. 696

bright idea
notebook & pen

...modern sensibility with extraordinary detailing...
in bright vinyl colors accented with silver trim



small, practical & totally efficient

	250	500	1000	2500	5000 and over
696	1.79	1.75	1.70	1.50	1.35
3ABC	Less than 250 quantity, add \$15.00 (G). Absolute Minimum - 100				

Item Size: 3" w x 4" h
Colors: LIME, ROYAL BLUE, BLACK
Imprint Color: White
Imprint Area: 1 3/4" w x 2" h
Shipping Weight: 25 lbs. per 250
Second Side Imprint: See General Information on Inside Front Cover
Imported

All catalog prices include a straight line imprint. Add a \$40.00 (G) Die Charge for logos or special type.
It is our policy to ship exact quantities: no overruns - no underruns.

Style No. 584

NOTE Jotter in
with 2 Year Calendar Card

LUSH, LIGHTLY FROSTED VINYL
SMOOTHIE
COLORS



	250	500	1000	2500	5000 and over
584	1.59	1.55	1.50	1.35	1.20
3ABC	Less than 250 quantity, add \$15.00 (G). Absolute Minimum - 100				

Item Size: 2 7/8" w x 4 3/8" h
Colors: STRAWBERRY, BLUE ICE, LIME
Imprint Color: White
Imprint Area: 2" w x 2 1/4" h
Shipping Weight: 23 lbs. per 250
Second Side Imprint: See General Information on Inside Front Cover
Imported

Style No. 796



The perfect way to keep your favorite photo close to you.

PHOTO NOTEBOOK

Rich vinyl padded cover with acetate covered window

	100	250	500	1000	2500 and over
796	2.29	2.24	2.18	1.95	1.75
3ABC	Less than 100 quantity, add \$15.00 (G). Absolute Minimum - 50				

Item Size: 3 3/4" w x 5" h
Colors: BLACK, BURGUNDY
Imprint Color: Gold or Silver (Please indicate)
Imprint Area: 2 1/2" w x 1 1/4" h
Shipping Weight: 15 lbs. per 100
Second Side Imprint: See General Information on Inside Front Cover
Imported



All catalog prices include a straight line imprint. Add a \$40.00 (G) Die Charge for logos or special type.
It is our policy to ship exact quantities: no overruns - no underruns.

Style No. 702

The Home Reminder

A Refrigerator Magnet & Note Pad

Things To Do



Imprint in any standard contrasting color

20 page lined note pad

Great \$ Value

	250	500	1000	2500	5000 and over
702	.98	.96	.94	.84	.75
3ABC	Less than 250 quantity, add \$10.00 (G). Absolute Minimum - 100				

Item Size: 3 1/2" w x 6" h

Colors: WHITE, RED

Imprint Color: Any standard contrasting color (Please indicate)

Imprint Area: 2 1/2" w x 1 1/8" h

Shipping Weight: 20 lbs. per 250

Second Side Imprint Not Available

Imported

Great advertising reminders for any business where the home is the focus.

Style No. 706

Mobile Reminder

A Refrigerator Magnet & Note Pad

Things To Do



NEW

20 page lined note pad

	250	500	1000	2500	5000 and over
706	1.19	1.16	1.14	.99	.89
3ABC	Less than 250 quantity, add \$15.00 (G). Absolute Minimum - 100				

Item Size: 3" w x 5" h

Color: BLACK

Imprint Color: Gold, Silver or White (Please indicate)

Imprint Area: 2 1/2" w x 1" h

Shipping Weight: 20 lbs. per 250

Second Side Imprint Not Available

Imported

All catalog prices include a straight line imprint. Add a \$40.00 (G) Die Charge for logos or special type. It is our policy to ship exact quantities: no overruns - no underruns.

Style No. 740

Magnetic Address & Phone Indexes

Matte Black or White

Items are
Credit Card
Size



All Magnetic Indexes
are inserted in
Clear Cases FREE!

Great \$ Value

	250	500	1000	2500	5000 and over
740	.79	.78	.77	.69	.62
3ABC	Less than 250 quantity, add \$10.00 (G). Absolute Minimum - 100				

Item Size: 3 1/4" w x 2 1/4" h
Colors: BLACK, WHITE
Imprint Color: Any standard contrasting color
(Please indicate)
Imprint Area: 2 1/2" w x 1 1/2" h
Shipping Weight: 17 lbs. per 250
Second Side Imprint: See General Information on
Inside Front Cover
Imported

Style No. 513

SLIDE & LOCK

Magnifier with Rulers in a Protective Vinyl Case

Fresnel Lens with
6X MAGNIFICATION

Emboss Printed
Rulers
in inches
and
centimeters

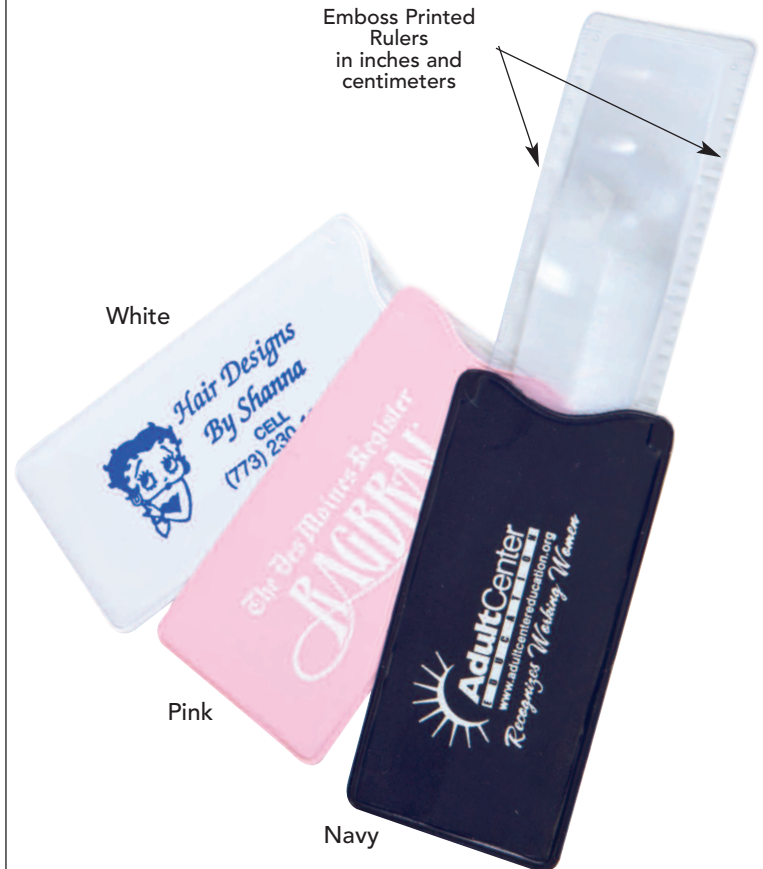

Protective Vinyl Case with pull-out stop

	250	500	1000	2500	5000 and over
513	.79	.78	.77	.69	.62
3ABC	Less than 250 quantity, add \$10.00 (G). Absolute Minimum - 100				

Item Size: 3 7/8" w x 1 7/8" h
Colors: NAVY, PINK, WHITE
Imprint Color: Any standard contrasting color
(Please indicate)
Imprint Area: 2 3/4" w x 1 1/4" h
Shipping Weight: 4 lbs. per 250
Second Side Imprint: See General Information on
Inside Front Cover
Imported

All catalog prices include a straight line imprint. Add a \$40.00 (G) Die Charge for logos or special type.
 It is our policy to ship exact quantities: no overruns - no underruns.

Style No. 515

CREDIT CARD SIZE MAGNIFIER



- Wafer thin
- Flexible and unbreakable
- Four attractive colors

Each Item is inserted
in a cello bag

Fresnel Lens with
5X
MAGNIFICATION

Great \$ Value

	250	500	1000	2500	5000 and over
515	.69	.68	.67	.60	.53
3ABC	Less than 250 quantity, add \$10.00 (G). Absolute Minimum - 100				

Item Size: 3 1/4" w x 2 1/4" h
 Colors: BLUE, WHITE, GREEN, RED
 Imprint Color: Any standard contrasting color
 (Please Indicate)
 Imprint Area: 2 3/4" w x 3/4" h
 Shipping Weight: 3 lbs. per 250
 Second Side Imprint: See General Information on
 Inside Front Cover
 Imported

Style No. 502

Lunette Clip-on Bookmark Magnifier

NEW



Clips onto the page

Fresnel Lens with
6X MAGNIFICATION

	250	500	1000	2500	5000 and over
502	.98	.96	.94	.84	.75
3ABC	Less than 250 quantity, add \$10.00 (G). Absolute Minimum - 100				

Item Size: 2 1/2" w x 3 7/8" h
 Colors: WHITE or NAVY
 Imprint Color: Any standard contrasting color (Please Indicate)
 Imprint Area: 2" w x 1 1/4" h
 Shipping Weight: 4 lbs. per 250
 Second Side Imprint Not Available
 Imported

All catalog prices include a straight line imprint. Add a \$40.00 (G) Die Charge for logos or special type.
 It is our policy to ship exact quantities: no overruns - no underruns.

Style No. 501

Readers Mark

Bookmark Magnifier with 5" Rulers



Rulers in inches and centimeters



Fresnel Lens with
6X MAGNIFICATION

Magnifier clips onto pages as bookmark

- Wafer thin
- Flexible & unbreakable
- Three attractive colors
- Each is inserted in a cello bag

	250	500	1000	2500	5000 and over
501	1.09	1.06	1.04	.92	.82
3ABC	Less than 250 quantity, add \$15.00 (G). Absolute Minimum - 100				

Item Size: 7 3/8" w x 2 1/2" h
 Colors: WHITE, PINK, NAVY
 Imprint Color: Any standard contrasting color (Please indicate)
 Imprint Area: 2" w x 1 1/2" h
 Shipping Weight: 5 lbs. per 250
 Second Side Imprint: See General Information on Inside Front Cover
 Imported

Style No. 516

Page Mark

Bookmark Magnifier with 4" Ruler



Fresnel Lens with
5X MAGNIFICATION

- Wafer Thin
- Flexible and unbreakable
- Four Attractive Colors
- Each is inserted in a cello bag

	250	500	1000	2500	5000 and over
516	.98	.96	.94	.84	.75
3ABC	Less than 250 quantity, add \$10.00 (G). Absolute Minimum - 100				

Item Size: 5 1/4" w x 1 3/4" h
 Colors: YELLOW, WHITE, BURGUNDY, NAVY
 Imprint Color: Any standard contrasting color (Please Indicate)
 Imprint Area: 1 3/4" w x 1" h
 Shipping Weight: 4 lbs. per 250
 Second Side Imprint: See General Information on Inside Front Cover
 Imported

All catalog prices include a straight line imprint. Add a \$40.00 (G) Die Charge for logos or special type.
 It is our policy to ship exact quantities: no overruns - no underruns.

Style No. 518

CREDIT CARD SIZE **MAGNIFIER**
IN A PROTECTIVE VINYL CASE

Vertical or Horizontal
Imprint available
(Please Specify)



Fresnel Lens with
5X MAGNIFICATION

Great \$ Value

	250	500	1000	2500	5000 and over
518	.79	.78	.77	.69	.62
3ABC	Less than 250 quantity, add \$10.00 (G). Absolute Minimum - 100				

Item Size: 3 1/2" x 2 3/8"

Colors: NAVY, WHITE, BURGUNDY

Imprint Color: Gold or any standard contrasting color (Please indicate)

Imprint Area: 2" x 1 1/2" (Indicate horizontal or vertical imprint)

Shipping Weight: 5 lbs. per 250

Second Side Imprint: See General Information on Inside Front Cover

Imported

Style No. 522

The
INSPECTOR
Magnifier

Fresnel Lens with
6X MAGNIFICATION

2 3/8" diameter lens



- Wafer thin
- Flexible & unbreakable
- Three attractive colors

Each Item is inserted in a cello bag

	250	500	1000	2500	5000 and over
522	.98	.96	.94	.84	.75
3ABC	Less than 250 quantity, add \$10.00 (G). Absolute Minimum - 100				

Item Size: 5 1/2" x 2 5/8"

Colors: WHITE, BLACK, RED

Imprint Color: Any standard contrasting color
(Please indicate)

Imprint Area: 2 1/4" x 3/4"

Shipping Weight: 4 lbs. per 250

Second Side Imprint: See General Information on
Inside Front Cover

Imported

All catalog prices include a straight line imprint. Add a \$40.00 (G) Die Charge for logos or special type.
It is our policy to ship exact quantities: no overruns - no underruns.

Style No. S-200

Sew Handy in a See-Thru Vinyl Case

Sewing Kit

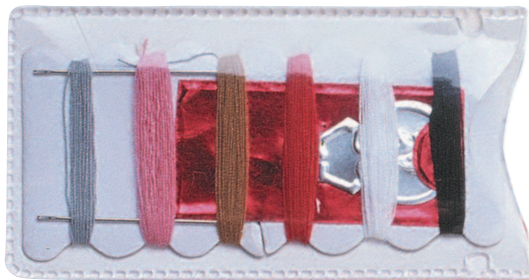

- Sewing Kit Features:
- Six different color threads,
 - Two needles and a threader



A must in every purse or briefcase!

Great \$ Value

	250	500	1000	2500	5000 and over
S-200	.79	.78	.77	.69	.62
3ABC	Less than 250 quantity, add \$10.00 (G). Absolute Minimum - 100				

Item Size: 3 3/4" w x 2" h
 Colors: RED, WHITE, ROYAL BLUE, BLACK
 Imprint Color: Any standard contrasting color (Please Indicate)
 Imprint Area: 2 5/8" w x 1 1/2" h
 Shipping Weight: 4 lbs. per 250
 Second Side Imprint Not Available
 Imported

Style No. 536

THE SEWING TRAY in a Booklet-style Case



	250	500	1000	2500	5000 and over
536	1.49	1.45	1.40	1.25	1.10
3ABC	Less than 250 quantity, add \$15.00 (G). Absolute Minimum - 100				

Item Size: 2 3/8" w x 3 1/8" h
 Colors: POPPY, AZURE, PLUM
 Imprint Color: White
 Imprint Area: 1 3/4" w x 2" h
 Shipping Weight: 17 lbs. per 250
 Second Side Imprint Not Available
 Imported

All catalog prices include a straight line imprint. Add a \$40.00 (G) Die Charge for logos or special type.
 It is our policy to ship exact quantities: no overruns - no underruns.

Style No. 503

SATIN NAIL CARE Set

Three Stainless Steel Tools
in a Frosted Translucent Vinyl Case



- Nail Clipper
- 4" Nail File
- Tweezers

Tools ship in a protective cello-bag



	250	500	1000	2500	5000 and over
503	1.79	1.75	1.70	1.50	1.35
3ABC	Less than 250 quantity, add \$15.00 (G). Absolute Minimum - 100				

Item Size: 2 1/2" w x 4 1/2" h
Colors: PINK, ICE BLUE
Imprint Color: White or Silver (Please Indicate)
Imprint Area: 1 3/4" w x 1 1/2" h
Shipping Weight: 24 lbs. per 250
Second Side Imprint Not Available
Imported

Style No. 532

Silver Flash TRAVEL KIT

Three Stainless Steel Nail Care Tools & a Sewing Kit in a Deluxe Vinyl Zip Case



- Nail Care Tools:**
- Clipper
 - Scissor
 - Tweezers

- Sewing Kit:**
- Nine Thread Colors
 - Two Needles
 - Three Replacement Buttons
 - One Safety Pin

The All-In-One Travel Kit

	50	100	250	500	1000 and over
532	3.39	3.35	3.29	2.98	2.72
3ABC	Less than 50 quantity, add \$15.00 (G). Absolute Minimum - 25				

Item Size: 4 3/4" w x 3" h
Color: SILVER
Imprint Color: Black or any contrasting color (Please indicate)
Imprint Area: 2 1/4" w x 1 1/4" h
Shipping Weight: 15 lbs. per 100
Second Side Imprint Not Available
Imported

All catalog prices include a straight line imprint. Add a \$40.00 (G) Die Charge for logos or special type. It is our policy to ship exact quantities: no overruns - no underruns.

Style No. C-310

Colorama

KEYTAGS

Choose from 15 attractive colors imprinted in any contrasting color.

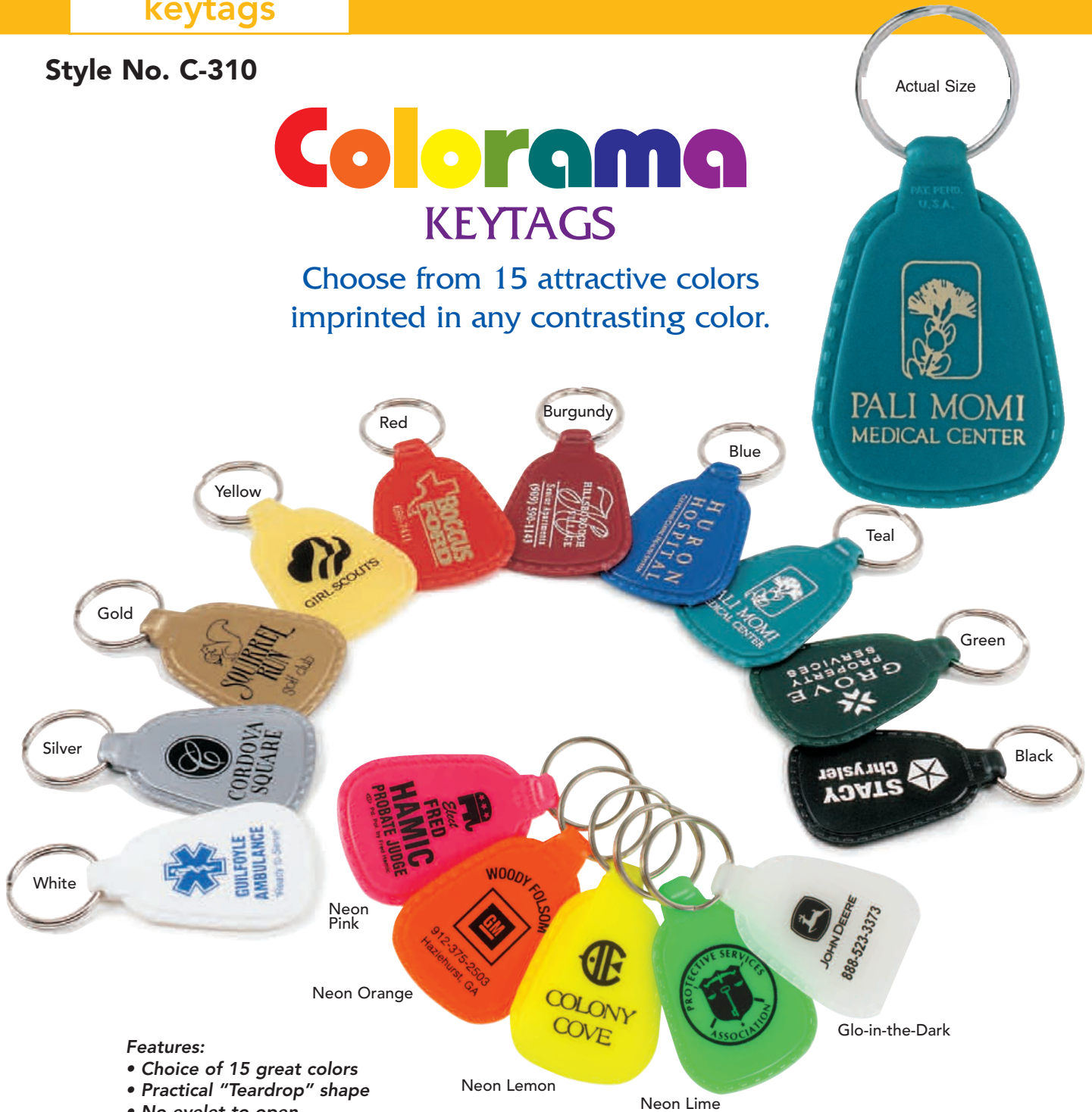

Features:

- Choice of 15 great colors
- Practical "Teardrop" shape
- No eyelet to open, so keytag will never come apart
- Tempered spring-steel split ring

Great \$ Value

	250	500	1000	2500	5000 and over
C-310	.49	.48	.47	.42	.37
3ABC	Less than 250 quantity, add \$10.00 (G). Absolute Minimum - 100				

Item Size: 1 3/4" w x 2 1/2" h

Colors: White, Silver, Gold, Yellow, Red, Burgundy, Blue, Teal, Green, Black, Glo-in-the-Dark, Neon Lime, Neon Lemon, Neon Orange, Neon Pink

Imprint Color: Any standard contrasting color (Please indicate)

Imprint Area: 1" w x 1 1/2" h

Shipping Weight: 5 lbs. per 250

Second Side Imprint: See General Information on Inside Front Cover

Made in U.S.A.

All catalog prices include a straight line imprint. Add a \$40.00 (G) Die Charge for logos or special type. It is our policy to ship exact quantities: no overruns - no underruns.

Style No. 835

the SAFARI KEYTAG

Outfitted with our unique and exclusive combo of a suede-style supported vinyl stitched to a coarse-weave Khaki nylon top.



	250	500	1000	2500	5000 and over
835	.98	.96	.94	.84	.75
3ABC	Less than 250 quantity, add \$10.00 (G). Absolute Minimum - 100				

Item Size: 2" w x 2 3/4" h
 Colors: (VINYL / Khaki Nylon) NAVY, HUNTER, SADDLE BROWN, RUST
 Imprint Color: Gold, Silver or White (Please indicate)
 Imprint Area: 1 1/4" w x 1 1/4" h
 Shipping Weight: 7 lbs. per 250
 Second Side Imprint: See General Information on Inside Front Cover
 Imported

Style No. 838

THE SAFARI CLIP

Carabiner with Woven Nylon Key Band in Safari Colors



Outfitted with our unique and exclusive combo of a suede-style supported vinyl stitched to a coarse-weave Light Khaki nylon band.

	250	500	1000	2500	5000 and over
838	1.79	1.75	1.70	1.50	1.35
3ABC	Less than 250 quantity, add \$15.00 (G). Absolute Minimum - 100				

Item Size: 6 1/2" x 1 3/4"
 Colors: (VINYL / Light Khaki Nylon Webbing) HUNTER, BURGUNDY, NAVY
 Imprint Color: Silver (Gold on request)
 Imprint Area: 1 1/4" w x 5/8" h
 Shipping Weight: 17 lbs. per 250
 Second Side Imprint Not Available
 Imported

All catalog prices include a straight line imprint. Add a \$40.00 (G) Die Charge for logos or special type. It is our policy to ship exact quantities: no overruns - no underruns.

Style No. F-380

THE **Flag Tag**



Actual Size

**IMPRINTED WITH YOUR
AD MESSAGE ON THE BACK**

	250	500	1000	2500	5000 and over
F-380	.79	.78	.77	.69	.62
C-360	.59	.58	.57	.51	.45
3ABC	Less than 250 quantity, add \$10.00 (G). Absolute Minimum - 100				

Style No. C-360

CROSS
KEYTAGS



Actual Size

Features on both
F-380 and C-360:

- No eyelet to open, so keytag will never come apart
- Tempered spring-steel split ring

Cross Keytags offer **FREE** optional imprinted slogans at no extra charge -- Pick one to go with your Ad Imprint. (Order by letter code as shown below).

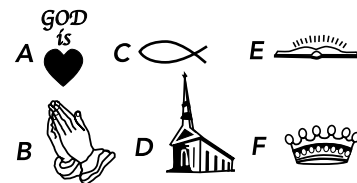

Item Size: F-380 - 2" w x 2" h;
C-360 - 1 7/8" w x 3 1/8" h

Color: White

Imprint Color:

F-380 - Dark Blue; C-360 - Gold;
or any standard contrasting color (Please indicate)

Imprint Area: F-380 - 1 1/4" w x 1" h
C-360 - 1 1/2" w x 1/2" h

Shipping Weight: 6 lbs. per 250

Second Side Imprint:

F-380 - Second Side Imprint Not Available

C-360 - See General Information on Inside Front Cover

Made in U.S.A.

All catalog prices include a straight line imprint. Add a \$40.00 (G) Die Charge for logos or special type.
It is our policy to ship exact quantities: no overruns - no underruns.

The richness and beauty of precious stones...crafted into life in magnificent keytags!

Style No. D-377

Diamond-cut
KEYTAGS

Style No. G-350

Gemcut
KEYTAGS



Actual Size



Emerald

Ruby

Sapphire

Diamond



Diamond



Aquamarine



Topaz



Amethyst

Each style features:

- The jewel-like clarity of precious stones
- Glittering precision-cut facets
- No eyelet to open, so keytag will never come apart
- Tempered spring-steel split ring



Actual Size

Item Size: D-377 - 2" w x 2 1/4" h;
G-350 - 1 1/2" w x 2 1/2" h

Colors: D-377 - Amethyst, Aquamarine, Diamond, Topaz or Assorted

G-350 - Sapphire, Emerald, Ruby, Diamond or Assorted

Imprint Color: Gold

Imprint Area: D-377 - 1 1/8" w x 1 1/8" h;
G-350 - 7/8" w x 1 1/2" h

Shipping Weight: D-377 - 8 lbs. per 250;
G-350 - 7 lbs. per 250

Second Side Imprint: See General Information on Inside Front Cover

Second Side Imprint Not Available on Clear

Made in U.S.A.

	250	500	1000	2500	5000 and over
D-377	.79	.78	.77	.69	.62
G-350	.79	.78	.77	.69	.62

3ABC Less than 250 quantity, add \$10.00 (G).
Absolute Minimum - 100

All catalog prices include a straight line imprint. Add a \$40.00 (G) Die Charge for logos or special type. It is our policy to ship exact quantities: no overruns - no underruns.

Style No. H-330

HEART
KEYTAGS



Actual Size

Heart Keytags offer FREE optional imprinted slogans at no extra charge -- Pick one to go with your Ad Imprint. (Order by letter code as shown below).

- | | |
|---------------------------------------|------------------------------|
| A - You're The HEART of Our Business! | E - I ♥ |
| B - "You'll LOVE Us!" | F - "Have a HEART-y Meal" |
| C - You'll ♥ Our Service | G - "You'll LOVE Our Prices" |
| D - "We Love Our Customers" | H - We're the folks with ♥ |

	250	500	1000	2500	5000 and over
H-330	.79	.78	.77	.69	.62
3ABC	Less than 250 quantity, add \$10.00 (G). Absolute Minimum - 100				

Item Size: 2" w x 2 3/8" h
 Color: Transparent Red
 Imprint Color: White
 Imprint Area: 1 1/2" w x 1 1/4" h
 Shipping Weight: 8 lbs. per 250
 Second Side Imprint: See General Information on Inside Front Cover
 Made in U.S.A.

Style No. H-300

homestyle®
KEYTAGS

Softee®



Flexible • Soft • Strong

VINYL
KEYTAGS

They're
Unbreakable

Both items feature:

- No eyelet to open, so keytag will never come apart
- Tempered spring steel split ring



Actual Size

- Realistic details on chimney and roofline



	250	500	1000	2500	5000 and over
H-300	.79	.78	.77	.69	.62
3ABC	Less than 250 quantity, add \$10.00 (G). Absolute Minimum - 100				

Item Size: 2 1/2" w x 1 3/4" h
 Colors: White, Red, Blue, Green or Assorted
 Imprint Color: White on Red, Blue and Green;
 Any standard color on White
 Imprint Area: 1 1/2" w x 1" h
 Shipping Weight: 8 lbs. per 250
 Second Side Imprint: See General Information on Inside Front Cover
 Made in U.S.A.

All catalog prices include a straight line imprint. Add a \$40.00 (G) Die Charge for logos or special type. It is our policy to ship exact quantities: no overruns - no underruns.

Style No. H-217

Salon Styler Comb



Pearl White



Black



	250	500	1000	2500	5000 and over
H-217	.69	.68	.67	.60	.53
3ABC	Less than 250 quantity, add \$5.00 (G). Absolute Minimum - 100				

Item Size: 6 1/2" w x 1 1/2" h
 Colors: PEARL WHITE, BLACK
 Imprint Color: Black on Pearl; White on Black
 Imprint Area: One Line, 30 letters and spaces
 Shipping Weight: 9 lbs. per 250
 Second Side Imprint: See General Information on Inside Front Cover
 Made in U.S.A.

Style No. H-219

VOLUMIZER SALON COMB



Lavender



Rose



	250	500	1000	2500	5000 and over
H-219	.69	.68	.67	.60	.53
3ABC	Less than 250 quantity, add \$5.00 (G). Absolute Minimum - 100				

Item Size: 6 1/2" w x 2 3/8" h
 Colors: LAVENDER, ROSE or Assorted
 Imprint Color: White
 Imprint Area: One Line, 40 letters and spaces
 Shipping Weight: 11 lbs. per 250
 Second Side Imprint: See General Information on Inside Front Cover
 Made in U.S.A.

All catalog prices include a straight line imprint. Add a \$40.00 (G) Die Charge for logos or special type.
 It is our policy to ship exact quantities: no overruns - no underruns.

unbreakable combs

Every ad-comb has the word "unbreakable" molded right in it. Guaranteed to last forever.



From Waldor

Style No. H-201 Unbreakable 5" Deluxe Pocket Comb



Available in Red, Blue, Green and Black

Style No. H-207 Unbreakable 7" Styling Comb



Black

Blue

Green

Red

Style No. H-208 Unbreakable 7" Dresser Comb



Black

Green

Blue

Red

Item Size: H-201 - 5" w x 1 3/16" h
 H-207 - 7" w x 1" h
 H-208 - 7" w x 1 1/4" h

Colors: RED, BLUE, GREEN, BLACK or Assorted
Imprint Color: White (Preferred) or Gold (Please indicate)

Imprint Area: One line, 40 letters and spaces

Shipping Weight: H-201 - 5 lbs per 250

H207 & H-208 -- 6 lbs. per 250

Second Side Imprint: See General Information on Inside Front Cover

Made in U.S.A.

	250	500	1000	2500	5000 and over
H-201	.39	.38	.37	.33	.29
H-207	.49	.48	.47	.42	.37
H-208	.49	.48	.47	.42	.37
3ABC	Less than 250 quantity, add \$5.00 (G). Absolute Minimum - 100				

All catalog prices include a straight line imprint. Add a \$40.00 (G) Die Charge for logos or special type.
 It is our policy to ship exact quantities: no overruns - no underruns.

unbreakable combs

Every ad-comb has the word "unbreakable" molded right in it. Guaranteed to last forever.

Style No. H-601 Unbreakable Ad-Comb®



**Buy
250
&
Get
250
FREE**

All orders packed with 250 Ad-combs® in an attractive display box

Available in our Great Jeweltone Colors: **RED, GREEN, BLUE, BLACK**

BUY: 250 Combs at	.45 ea.	GET: 250 Extra	FREE
500 Combs at	.44 ea.	500 Extra	FREE
1000 Combs at	.39 ea.	1000 Extra	FREE
2500 Combs at	.35 ea.	2500 Extra	FREE
5000 Combs at	.31 ea.	5000 Extra	FREE
12,500 Combs at	.28 ea.	12,500 Extra	FREE

2ABCDE ABSOLUTE MINIMUM - 250 WITH 250 FREE
Need a quote on larger quantities? Just call or fax in your request.

Item Size: 5" w x 1" h

Colors: RED, GREEN, BLUE, BLACK or Assorted

Imprint Color: White (Preferred) or Gold (Please indicate)

Imprint Area: One line, 40 letters and spaces

Shipping Weight: 14 lbs. per 1000

Cello Bags: \$70.00 (G) per 1000 for the entire quantity.

EXAMPLE: If order is for 1000 plus 1000 free, the charge would be \$140.00(G).

Change of Copy: \$5.00 (G) per change.

Second Side Imprint: \$.05 each (G) for the entire quantity plus \$5.00 (G) set-up charge.

EXAMPLE: If order is for 500 plus 500 free, the charge would be \$55.00 (G)

Made in U.S.A.

Great \$ Value



All catalog prices include a straight line imprint. Add a \$40.00 (G) Die Charge for logos or special type.
It is our policy to ship exact quantities: no overruns - no underruns.

sale items

Close-out products offered at substantially less than EQP.

- The prices are for 250 quantities and over; less than 250 quantity, add \$5.00 (G). Absolute Minimum 100.
- For all other General Ordering Information see Inside Front Cover.

All Items Are Imported. • Single price for any quantity. • Offer good while supplies last.

Style No. 846

EASY VIEW Back Pack

Ultra-Light and compact with mesh front makes it easy to find contents.



\$1.89
EACH (C)

Size: 14 3/4" w x 17" h; Black Mesh Bag with RED Vinyl Panel; Black Nylon Back; Imprint color - Gold, Silver or White (Please Indicate); Imprint Area - 6" w x 2" h; Shipping Wt. - 16 lbs per 100

Style No. 912

TRAVEL-LITE ID Wallet

A sporty, casual, lightweight wallet constructed in Microfiber. Features a full-size Billfold, 3 Credit Card Slots, ID Card Window and Multi-Purpose Pockets.



\$1.19
EACH (C)

Size: 3 1/4" w x 4 3/8" h; Khaki Microfiber / BURGUNDY Vinyl Panel or Gray Microfiber / NAVY Vinyl Panel; Imprint color - Gold, Silver or White (Please Indicate); Imprint Area - 1 3/4" w x 2" h; Shipping Wt. - 22 lbs per 250

Style No. 252

iSAC - cell / electronics case

Snaps to your belt, handbag or backpack. Padded for protection.



\$1.19
EACH (C)

Size: 3" w x 6" h; Available in ELECTRIC BLUE, BRIGHT RED, EVERGREEN; Imprint color - Gold or Silver (Please Indicate); Imprint Area - 1 3/4" w x 1 1/2" h; Shipping Wt. - 11 lbs per 250

Style No. 730

THE CD CADDY in Smoothie Colors

12 CD snap case with cushioned sleeves. Clear frosted ribbed vinyl spine.



89¢
EACH (C)

Size: 5 3/4" w x 5 1/2" h; Available in BLUE ICE, LIME or STRAWBERRY; Imprint color - White; Imprint Area - 2 1/4" w x 3" h; Shipping Wt. - 25 lbs per 250

Style No. 812

ON THE MEND First Aid & Sewing Kit

First Aid Supplies: Three 3/4" Bandages, 1 Sting Relief Pad, 3 Sterile Alcohol Pads, 1 Antiseptic Towelette;
Sewing Kit: 6 different color threads, a Threader & 2 Needles.



\$1.49
EACH (C)

Size: 4 3/8" w x 3 3/8" h; Available in RED Vinyl / White Microfiber; Imprint color - White; Imprint Area - 2 1/2" w x 1 1/4" h; Shipping Wt. - 20 lbs per 250

All catalog prices include a straight line imprint. Add a \$40.00 (G) Die Charge for logos or special type. It is our policy to ship exact quantities: no overruns - no underruns.

- The prices are for 250 quantities and over; less than 250 quantity, add \$5.00 (G). Absolute Minimum 100.
- For all other General Ordering Information see Inside Front Cover.

All Items Are Imported. • **Single price for any quantity.** • **Offer good while supplies last.**

Style No. 925

The COSMETIC TRAVELER

A large cosmetic tote in frosted translucent vinyl with matching zipper and pull tab.

Water-resistant satin finish vinyl.



99¢
EACH (C)

Size: 9 3/4" w x 8 1/4" h x 3" d; Available in PALE PINK;
Imprint color - Any contrasting color (Please Indicate)
Imprint Area - 3 1/2" w x 2" h; Shipping Wt. - 40 lbs per 250

Style No. 886

COLOR TECH Junior Notebook & Pen

Rigid vinyl cover with a 30 page Junior Size lined pad and a retractable white pen in an elastic pen loop.



\$1.89
EACH (C)

Size: 6 1/4" w x 8 1/2" h; BLUE ICE or ELECTRIC RED with a Silver Spine;
Imprint color - White or Silver (Please Indicate);
Imprint Area - 3" w x 2 1/2" h; Shipping Wt. - 44 lbs per 100

Style No. 928

The COSMETIC PURSE in Pebble Grain Vinyl



89¢
EACH (C)

Size: 7 3/4" w x 4" h; Available in NAVY or SCARLET;
Imprint color - Gold or Silver (Please Indicate);
Imprint Area - 3 1/2" w x 1 3/4" h; Shipping Wt. - 19 lbs per 250

Style No. 250

THE CELL SAC Mobile Phone Carrier

Vinyl / Nylon combination - Features a belt clip, ring for lanyard and velcro closure.



79¢
EACH (C)

Size: 2 3/8" w x 5" h; Available in NAVY with Gray trim and Black elastic or GRAPHITE with Black trim and Black elastic; Imprint color - Silver; Imprint Area - 1 1/4" w x 1 1/2" h; Shipping Wt. - 21 lbs per 250

Style No. 586

POCKET PAL Address & Phone Book
Supple Vinyl Cover with sewn binding

24 alphabetically tabbed pages with room for 288 single line entries.



39¢
EACH (C)

Size: 3 1/4" w x 2 3/4" h; Available in BURGUNDY, BLACK, NAVY;
Imprint color - Gold, Silver or White (Please Indicate);
Imprint Area - 2" w x 2" h; Shipping Wt. - 6 lbs per 250

All catalog prices include a straight line imprint. Add a \$40.00 (G) Die Charge for logos or special type.
It is our policy to ship exact quantities: no overruns - no underruns.

- The prices are for 250 quantities and over; less than 250 quantity, add \$5.00 (G). Absolute Minimum 100.
- For all other General Ordering Information see Inside Front Cover.

All Items Are Imported. • Single price for any quantity. • Offer good while supplies last.

Style No. 580

NOTE POSTER in Smoothie Colors
with a refillable 3" x 3" 50 sheet sticky note pad.

89¢
EACH (C)



Size: 3 1/4" w x 3 1/4" h; BLUE ICE, STRAWBERRY; Imprint color - White;
Imprint Area - 2 1/4" w x 1 1/2" h; Shipping Wt. - 25 lbs per 250

Style No. 150

Bonded Leather EXECUTIVE MONEY POUCH

Just squeeze and it opens... release and it snaps shut - tight.

69¢
EACH (C)



Size: 3 7/8" w x 3 1/4" h; Available in BRITISH TAN or BURGUNDY;
Imprint color - Gold; Imprint Area - 2 1/2" w x 1 1/4" h;
Shipping Wt. - 12 lbs per 250

Style No. 705

PICTURE PERFECT

A Refrigerator Magnet & Photo Holder

White Refrigerator Magnet with clear pocket for family photos.
Fits photos up to 3 1/4" x 3 1/4".

45¢
EACH (C)



Size: 3 1/2" w x 6" h; Available in WHITE;
Imprint color - Any standard color. (Please Indicate);
Imprint Area - 2 1/2" w x 1 1/2" h; Shipping Wt. - 9 lbs per 250

Style No. 840

KOOL KUP Insulated Beverage Holder

Fits any standard 12 oz can or bottle.

65¢
EACH (C)



Size: 4" w x 4 1/4" h; Available in BRIGHT RED, EVERGREEN,
ELECTRIC BLUE; Imprint color - Gold or Silver (Please Indicate);
Imprint Area - 2 1/2" w x 2 1/2" h; Shipping Wt. - 14 lbs per 250

Style No. 523

ACRYLIC MAGNIFIER

3X Fresnel Lens panel and an inset 6X Birdseye Lens.
(Each inserted in a Cello Bag).

39¢
EACH (C)



Size: 2" w x 3 1/4" h; Available in WHITE or NAVY; Imprint color - White on
Navy, Any Contrasting Color on White (Please Indicate);
Imprint Area - 1 1/2" w x 3/4" h; Shipping Wt. - 6 lbs per 250

Style No. 527

6X MAGNIFIER In TechnoColor frosted vinyl cases.

39¢
EACH (C)



Size: 3 3/4" w x 2 1/2" h; Available in CHERRY, LIME,
BLUEBERRY or PINK; Imprint color - White;
Imprint Area - 2 3/4" w x 1 1/2" h;
Shipping Wt. - 5 lbs per 250

All catalog prices include a straight line imprint. Add a \$40.00 (G) Die Charge for logos or special type.
It is our policy to ship exact quantities: no overruns - no underruns.

- The prices are for 250 quantities and over; less than 250 quantity, add \$5.00 (G). Absolute Minimum 100.
- For all other General Ordering Information see Inside Front Cover.

All Items Are Imported. • Single price for any quantity. • Offer good while supplies last.

Style No. 738

THE CD PROTECTOR in Safari Colors

12 CD zip case with protective sleeves in matching colors.

99¢
EACH (C)



Size: 6" w x 5 1/2" h; Available in BURGUNDY or NAVY with Khaki Nylon Spine; Imprint color - Gold; Imprint Area - 3" w x 1 1/2" h; Shipping Wt. - 22 lbs per 100

Style No. 725

THE RONDO CD Carrier

Padded Vinyl cover. Holds 12 CDs in protective sleeves.

89¢
EACH (C)



Size: 6 1/4" w x 6 1/4" h; Available in SEA GREEN; Imprint color - White or Black; Imprint Area - 3" w x 2" h; Shipping Wt. - 31 lbs per 100

Style No. 913

STREET SMART ID Wallet

in Black Cowhide Textured Vinyl. Secure Zipper pocket, 3 Credit Card Slots, ID Card Window and Multi-Purpose Pockets. Gold metal corners.

\$1.19
EACH (C)



Size: 3" w x 4 1/8" h; BLACK Cowhide Textured Vinyl; Imprint color - Gold, Silver or White (Please Indicate); Imprint Area - 1 3/4" w x 2" h; Shipping Wt. - 20 lbs per 250

Style No. 145

Bonded Leather EXECUTIVE KEY FOB

Features a contemporary flat keyring and edge stitching.

89¢
EACH (C)



Size: 1 1/2" x 2 7/8"; Available in BRITISH TAN, BURGUNDY, NAVY; Imprint color - Gold; Imprint Area - 5/8" x 1 1/2"; Shipping Wt. - 9 lbs per 250

Style No. 529

THE LOUPE Swivel Case Magnifier

Fresnel Lens with 6X Magnification; Rigid polypropylene Protective Swivel Case.

75¢
EACH (C)



Size: 2 3/4" w x 2 3/4" h; Available in BLUE, WHITE, RED; Imprint color - Any standard color (Please Indicate); Imprint Area - 1 3/4" w x 1" h; Shipping Wt. - 4 lbs per 250

All catalog prices include a straight line imprint. Add a \$40.00 (G) Die Charge for logos or special type. It is our policy to ship exact quantities: no overruns - no underruns.



Sunny Day Electronics Carrier
(Style No. 560) see page 25



The Fashionista Zip Purse
(Style No. 755) see page 12



The Cosmetique Cosmetic Bag
(Style No. 727) see page 15



The Metropolitan Monthly Pocket Planners
(Style No. 615) see page 39



Travel Mate
(Style No. 270)
see page 35



Mobile Guard
(Style No. 256) see page 24

The Sport Wallet
(Style No. 917)
see page 27

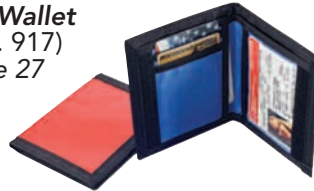

Card Mate
(Style No. 260) see page 35



First Class Cosmetic Bag
(Style No. 729) see page 19



Mobile Reminder
(Style No. 706)
see page 55



Lunette Bookmark Magnifier
(Style No. 502) see page 57



The White Mesh Twin Zip
(Style No. 942) see page 9



Rainbow Colors First Aid Kit
(Style No. 816) see page 22

New Colors...



The School Mate Pencil Case
(new color Lemon)
(Style No. 728)
see page 21

Metallic Color Monthly Pocket Planner
(new color Steel Gray)
(Style No. 512)
see page 36



The Contempo Weekly Pocket Planners
(Style No. 970) see page 41



Fun Color Zip Purse
(new color Navy/Red)
(Style No. 787)
see page 3



iCase eyeglasses/iPod/cell
(new color Royal Blue)
(Style No. 255)
see page 26